

USER MANUAL  
BENUTZERHANDBUCH  
UŽIVATELSKÝ MANUÁL  
POUŽIVATEĽSKÝ MANUÁL  
HASZNÁLATI ÚTMUTATÓ



**EN** PROFESSIONAL GAMING MOUSE  
**DE** PROFI GAMING-MAUS  
**CZ** PROFESIONÁLNÍ MYŠ PRO HRÁČE  
**SK** PROFESIONÁLNA HERNÁ MYŠ  
**HU** PROFI GAMER EGÉR

CMO-8080-BK



## THANK YOU FOR BUYING A CONNECT IT PRODUCT.

Do you want to be the first to know about other news of CONNECT IT? Follow us on social media.



YouTube



#connectit

- Before putting this product into operation please read through the User's Manual carefully, even if you are already familiar with the use of similar products. Use the product only as described in this User's Manual.
- Keep this User's Manual for future reference. It is an integral part of the product and may contain important instructions for commissioning this product, its operation and cleaning.
- Make sure that all other people handling this product are familiar with this Manual. If you hand the product over to other people, make sure that they read this User's Manual, which shall be given to them together with the product.

We recommend keeping the original packaging of the product, proof of purchase and the warranty card, if supplied, at least for the warranty period. In case of transport, we recommend packing the product in the original packaging, in which it has been delivered in, as it protects it best against damage during transport.

Scan this QR code to get the latest version of the User's Manual. In your smartphone, open the QR code reader application and point the smartphone at this code – the page for downloading the latest version of the User's Manual will open:



You can also find the latest version of the User's Manual on our website [www.connectit-europe.com](http://www.connectit-europe.com)

The text and technical specifications are subject to change.



## 1 Technical specification

- 2.4 GHz wireless connection
- Receiver range up to 10 m
- 7 buttons including scroll wheel
- 6 RGB backlight modes
- Ergonomic design for 3 gaming mouse grips (Claw/Fingertip/Palm)
- SW for free
- Pixart PAW3325 precise and sensitive optical sensor
- Huano mechanical switches (20 million clicks lifetime)
- Resolution: 1000/1600/3200/5000 DPI (default settings)
- DPI software settings: 100 - 10 000 DPI
- 125-250-500-1000 Hz polling rate
- 20 G acceleration
- Mouse battery: Li-ion 500 mAh
- Play time: up to 34 hours (without backlight)
- Charging dock cable length: 180 cm
- Length of additional mouse cable (USB-C → USB-A): 150 cm
- Easy Plug & Play installation
- USB 2.0 backward compatible with USB 1.1
- Mouse dimensions: 68 x 130 x 41 mm
- Charging dock dimensions: 40 x 73 x 41 mm
- Mouse weight: 115 g
- Charging dock weight: 105 g

System requirements: Universal Windows and Mac OS compatibility (product features not supported by Mac OS may not work properly)

## 2 Description of Each Part

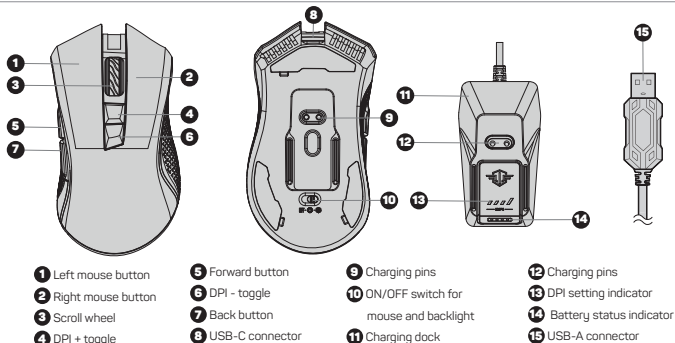

## 3 Installation

Plug the gaming mouse into the computer and install the software that is available at [www.connectit-europe.com](http://www.connectit-europe.com).

1. Click on **Next**.
2. Select the destination folder and click **Next** to confirm. To select a different destination folder, click **Browse**, select another folder, and then click **OK**.
3. Press the **Install** button to start the program installation.
4. Click **Finish** to complete the installation.

## 4 Software

This mouse comes with user software where you can create macros, reconfigure mouse buttons, edit mouse properties, change mouse backlighting and all of this can be stored in 5 different user profiles.

### User profiles

The software has tabs for up to 5 user profiles. You can save individual profiles to disk (Export) or upload already created profiles (Import). Changes made to the profile can be saved by clicking „Apply“; if you do not wish to save the changes, click „Cancel“.



# Obsah je uzamčen

**Dokončete, prosím, proces objednávky.**

**Následně budete mít přístup k celému dokumentu.**



**Proč je dokument uzamčen? Nahněvat Vás rozhodně nechceme. Jsou k tomu dva hlavní důvody:**

- 1) Vytvořit a udržovat obsáhlou databázi návodů stojí nejen spoustu úsilí a času, ale i finanční prostředky. Dělali byste to Vy zadarmo? Ne\*. Zakoupením této služby obdržíte úplný návod a podpoříte provoz a rozvoj našich stránek. Třeba se Vám to bude ještě někdy hodit.

*\*) Možná zpočátku ano. Ale vězte, že dotovat to dlouhodobě nelze. A rozhodně na tom nezbohatneme.*

- 2) Pak jsou tady „roboti“, kteří se přiživují na naší práci a „vysávají“ výsledky našeho úsilí pro svůj prospěch. Tímto krokem se jim to snažíme překazit.

A pokud nemáte zájem, respektujeme to. Urgujte svého prodejce. A když neuspějete, rádi Vás uvidíme!