

delimano®

18 IN 1 MULTI COOKER



INSTRUCTION MANUAL

Model no.: KF-R50

PICTURES.....	2	HU.....	20	RO.....	41
EN.....	2	KS.....	22	RS.....	44
AL.....	4	LT.....	25	RU.....	46
BIH.....	7	LV.....	28	SI.....	50
BG.....	9	MD.....	30	SK.....	52
CZ.....	12	ME.....	33	UA.....	55
EE.....	15	MK.....	35	EN / EXPLANATION OF THE MARKING.....	58
HR.....	17	PL.....	38		

(EN) PICTURES / (AL) FOTOGRAFIN / (BA) SLIKE / (BG) ИЛЮСТРАЦИИ / (CZ) OBRÁZKY / (EE) JOONISED / (HR) SLIKE / (HU) KÉPEK / (KS) FOTOGRAFIN / (LT) PAVEIKSLIAUKAI / (LV) ATTĒLI / (MD) IMAGINI / (ME) SLIKE / (MK) СЛИКИ / (PL) RYSUNKI / (RO) IMAGINI / (RS) SLIKE / (RU) RYSUNKI / (SI) SLIKE / (SK) OBRÁZKY / (UA) МАЛЮНКИ

EN

Dear customer! Many thanks for selecting our **Delimano 18in1 Multicooker**! All Delimano products are perceived very valuable, so counterfeiters really like to copy us and thus abuse customers by worse quality with no warranty and service. Please, report any copied, counterfeited, similar product or unauthorised distributor to brand.protection@studio-moderna.com in order to help us fighting against illegal counterfeits. For **Delimano 18in1 Multicooker** you just bought we guarantee that by carefully following instructions below and with appropriate care you will enjoy many confident years with the **Delimano 18in1 Multicooker**. **Read this manual thoroughly before using and save it for future reference.**

Delimano 18in1 Multicooker – Instruction Manual

1) Important Safeguards

- 1. Use of applicable container for cooking only** - Use of inapplicable container for cooking may lead to poor heat conduction affecting the food quality, and even resulting in failure or any other unforeseen accident.
- 2. Place of use (location)** - This device is intended for household use only. It is not allowed to place this product on an unstable, gas oven or near to any other high-temperature article for avoidance of deformation which may result in functional failure. The inner pot is not allowed to be used with other heaters.
- 3. Children safety** - This device can be used by children aged from 8 years and above as well as by persons with reduced physical, sensory or mental capabilities or lack of experience and knowledge if they have been given supervision or instruction concerning use of the device in a safe way and understand the hazards involved. Children should not play with the device. Cleaning and user maintenance should not be done by children unless they are older than 8 and supervised.
- 4. Keep inner pot and heater clean** - Keep the inner pot, heater and internal side of the cooker clean to avoid over burning which may result in failure or other unforeseen accidents.
- 5. Storage and protection of power wire** - For use and storage of power wires, it is not allowed to process, damage, pull, twist, lengthen or allow any heavy object to press the power wires to avoid any failure or accident resulted from the damage of wire skin. In case the wire is damaged, please stop using the device immediately and contact support service for replacement.
- 6. No dishcloth or other item allowed to cover this product** - During cooking or warm keeping, it is not allowed to cover air outlet with any object because it may lead to functional failure caused by the deformation of cooker body.
- 7. Switch operation or shutdown of power is not advised during cooking** - Operation of switch or power shutdown may affect the food quality caused by uneven heating performance.
- 8. No washing with water** - No washing with water is allowed to clean the cooker body. It is not also allowed to immerse this entire cooker into water for avoidance of functional failure, electric shock or any other unforeseen accident.

Pic. 1

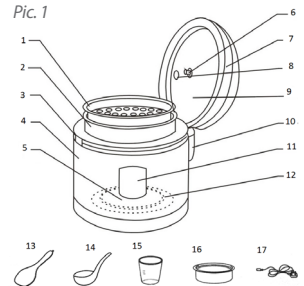

9. Do not turn power on when inner pot is not inside - It is not allowed to turn the power on when the cooker is not loaded or the inner pot hasn't been put inside to avoid the fuse being burnt or any accident.

10. This device should never operate empty, because such action could result in appliance failure and/or injuries to the user.

11. High-Temperature Steam When Cooking - When cooking, steam may come from the air outlet, so it is not allowed to close your face or hands to the outlet and the upper lid for avoidance of scald.

12. Make sure to use the device with correct power source- If the voltage is less than 220V, the heater is unable to work normally leading to poor cooking performance; if the voltage is more than 220V, it may cause damage to the circuit resulting in fire or any other unforeseen accident.

13. Don't share one socket with other electric appliances - Sharing one socket with other electric appliances may lead to overheat of the socket causing fire or any other unforeseen accident.

14. Unauthorized disassembly, repair or reconstruction is not allowed - Unauthorized disassembly or reconstruction may lead to unforeseen failure or accidents, causing serious breach of customer's rights and interests.

15. Put Inner Pot into Electric Cooker - Dry the inner pot and confirm there are no impurities on the heater. Put the inner pot in the electric cooker and then turn the inner pot around to allow the pot to be in full contact with the heater. Don't fill water in the outer pot to avoid any failure or electric shock.

16. Although the device has been checked its usage and consequences are strictly user responsibility.

2) Parts

Main parts of the product:

Pic. 1 (see: PICTURES, Pic. 1)			
1. steamer	6. pin	11. control panel	16. steamer
2. inner pot (capacity 5l)	7. cover lid	12. hot plate	17. power cord
3. outer pot	8. steam hole	13. spoon	
4. body	9. keep warm lid	14. ladle	
5. temperature control unit	10. excess water catcher	15. measuring cup	

3) Rating

Item Number	KF-R1150 (touch panel)
Voltage	220-240 V~ , 50Hz
Power	700 W
Capacity	5L
Number of persons served	5-10

4) Usage

Operation:

1. Connected the power cord. Plug in.

The LED display and function names will be light on, the left LED will show you "00:00", the small LED display will show the bottom temperature. This is stand-by mode.

2. Choose the function you want:

Press the MENU key, the big LED display will show the default cooking time, the function which have been chosen will spark, press "START" button to work. when working, the function indicator light will light, other functions' light will not light.

You can also choose functions by press "+" and "-" is forward, and "-" is backward.

2a) You can adjust the cooking time

After choosing the function you need, the big LED display will show you the default cooking time, press "Temperature/time" button, then press the "Hour/+" or "Min/-" key ("+" is to increase the cooking time, "-" is to reduce the cooking time,) to adjust cooking time. And after setting, press "START".

2b) You can adjust the temperature

For FRY and Custom function, user can set the temperature.

Choose FRY or Custom function, press the "Temperature/ Time" button, the left LED display will spark, then press "Hour/+" or "Min/-" to set the cooking time, and then press the "Temperature/ Time" button again, the right LED display will spark, use the "Hour/+" or "Min/-" key to set the temperature ("Hour/+" is to increase the cooking temperature, "Min/-" is to reduce the cooking temperature,) after setting then press "Start".

Remark: "Cooking time" and "cooking temperature" is the same key, press the key one time, it will be "Cooking time" adjust, and press this key again, it will be "Cooking temperature" adjust.

3. Cancel/keep warm

- When plug in, the cooker is stand by, press "cancel/ keep warm", the cooker will turns into "keep warm" mode. The indicator will be on. And the display will show the keep warm time.

- During your operations/ settings, if press this button, it will go back to stand-by mode.

Obsah je uzamčen

Dokončete, prosím, proces objednávky.

Následně budete mít přístup k celému dokumentu.



Proč je dokument uzamčen? Nahněvat Vás rozhodně nechceme. Jsou k tomu dva hlavní důvody:

- 1) Vytvořit a udržovat obsáhlou databázi návodů stojí nejen spoustu úsilí a času, ale i finanční prostředky. Dělali byste to Vy zadarmo? Ne*. Zakoupením této služby obdržíte úplný návod a podpoříte provoz a rozvoj našich stránek. Třeba se Vám to bude ještě někdy hodit.

**) Možná zpočátku ano. Ale vězte, že dotovat to dlouhodobě nelze. A rozhodně na tom nezbohatneme.*

- 2) Pak jsou tady „roboti“, kteří se přiživují na naší práci a „vysávají“ výsledky našeho úsilí pro svůj prospěch. Tímto krokem se jim to snažíme překazit.

A pokud nemáte zájem, respektujeme to. Urgujte svého prodejce. A když neuspějete, rádi Vás uvidíme!