

Select a language:

EN – English

DE – Deutsch

FR – Français

IT – Italiano

ES – Español

NL – Nederlands

NO – Norsk

FI – Suomi

SV – Svenska

DA – Dansk

CZ – Český

PL – Polski

SK – Slovenský

RU – Русский

JP – 日本語

CS – 简体中文

CT – 繁體中文

KO – 한국어

**MULTI-LANGUAGE QUICK START GUIDE DOWNLOAD**

- creative.com/support/SensemoreAir
- [FR] TÉLÉCHARGEMENT DU GUIDE DE DÉMARRAGE RAPIDE MULTI-LANGUES
- [DE] MEHRSPRACHIGE SCHNELLSTARTANLEITUNG HERUNTERLADEN
- [ES] DESCARGA DE LA GUÍA DE INICIO RÁPIDO EN MÚLTIPLES IDIOMAS
- [IT] DOWNLOAD DELLA GUIDA DI AVVIO RAPIDO MULTILINGUA
- [NL] MEERTALIGE SNELSTARTGIDS DOWNLOAD
- [RU] МНОГОЯЗЫЧНОЕ КРАТКОЕ РУКОВОДСТВО ЗАГРУЗИТЬ
- [PL] POBIERZ PRZEWODNIK SZYBKIEGO STARTU W WIELU JĘZYKU
- [CZ] STÁHNOUT VÍCEJAZYKOVÝ RYCHLÝ NÁVOD K POUŽITÍ
- [SK] STIAHNŮT SI RÝCHLY NÁVOD NA ŠTARTOVANIE VIAC JAZYKOV
- [JP] 多言語クイックスタートガイドのダウンロード
- [CS] 多语言快速入门指南下载
- [CT] 多語言快速入門指南下載
- [KO] 다국어 빠른 시작 가이드 다운로드
- [NO] NEDLASTING AV HURTIGSTARTVEILEDNING FOR FLERE SPRÅK
- [FI] MONIKIELINEN PIKA-ALOITUSOPPAAN LATAUS
- [SV] FLERSPRÅKIG SNABBSTARTGUIDE LADDNA ER
- [DA] DOWNLOAD AF HURTIG STARTVEJLEDNING PÅ FLERE SPROG

CREATIVE®

SENSEMORE AIR

Lightweight True Wireless Sweatproof In-ears with Sensemore Technology

QUICK START GUIDE
快速入门指南
快速入門指南

使用产品前请阅读使用说明

Model No. / 型号 / 型號: EF1020

PN: EN 03EF102000000 Rev A

REGISTER YOUR PRODUCT
creative.com/register

TECHNICAL SUPPORT
creative.com/support

OVERVIEW

a Charging Case Battery Indicator

i) Charging Indicator

Charging	● Glowing Red
Fully Charged	● Solid Green

ii) Battery Level

Low	● Solid Red
Medium	● Solid Yellow
High	● Solid Green

b Left Earbud Charging Indicator

c Right Earbud Charging Indicator

i) Earbuds Charging Indicator

Charging	● Glowing Red
Fully Charged	● Solid Green

e Earbuds LED Indicator

Disconnected	⚙️ Blinking Blue
Bluetooth® Pairing	🔴 Blinking Red and Blue
Charging	🔴 Glowing Red (In Charging Case)
Fully Charged	⚪ LED Off

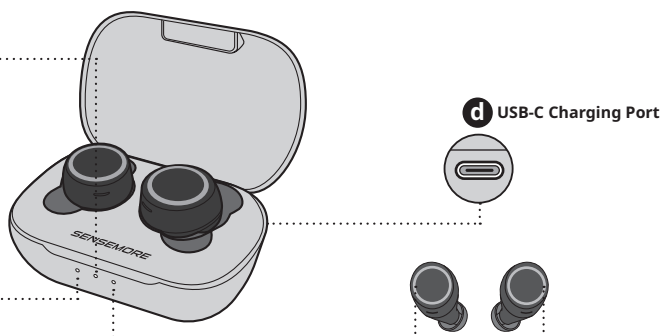

CONTROLS

i) Playback Mode

L	R												
<table border="1"> <tr> <td>👉 x2</td> <td>Sensemore Mode / Active Noise Cancellation / Off</td> </tr> <tr> <td>👉 x3</td> <td>Siri / Google Assistant</td> </tr> <tr> <td>👉 3s</td> <td>🔊 -</td> </tr> </table>	👉 x2	Sensemore Mode / Active Noise Cancellation / Off	👉 x3	Siri / Google Assistant	👉 3s	🔊 -	<table border="1"> <tr> <td>👉 x2</td> <td>▶️ </td> </tr> <tr> <td>👉 x3</td> <td>⏮️ ⏭️</td> </tr> <tr> <td>👉 3s</td> <td>🔊 +</td> </tr> </table>	👉 x2	▶️	👉 x3	⏮️ ⏭️	👉 3s	🔊 +
👉 x2	Sensemore Mode / Active Noise Cancellation / Off												
👉 x3	Siri / Google Assistant												
👉 3s	🔊 -												
👉 x2	▶️												
👉 x3	⏮️ ⏭️												
👉 3s	🔊 +												

Note: Certain playback functions can be customized through the Creative app when connected via Bluetooth

ii) Call Mode

L	R								
<table border="1"> <tr> <td>👉 x2</td> <td>📞 / 🔄</td> </tr> <tr> <td>👉 3s</td> <td>🚫</td> </tr> </table>	👉 x2	📞 / 🔄	👉 3s	🚫	<table border="1"> <tr> <td>👉 x2</td> <td></td> </tr> <tr> <td>👉 3s</td> <td>🔊 +</td> </tr> </table>	👉 x2		👉 3s	🔊 +
👉 x2	📞 / 🔄								
👉 3s	🚫								
👉 x2									
👉 3s	🔊 +								
L	R								
<table border="1"> <tr> <td>👉 3s</td> <td>🔊 -</td> </tr> </table>	👉 3s	🔊 -	<table border="1"> <tr> <td>👉 3s</td> <td>🔊 +</td> </tr> </table>	👉 3s	🔊 +				
👉 3s	🔊 -								
👉 3s	🔊 +								

iii) Entering Bluetooth Pairing Mode Manually

L	R
👉 3s	👉 3s

Note: The earbuds can only manually enter Bluetooth Pairing mode when no audio is being played.

iv) Powering On / Off Earbuds Manually

L	R
👉 6s	🔴 OFF
👉 3s	🔴 ON

PERSONALIZING NOISE CONTROL FEATURES

Sensemore Mode

Our proprietary technology engineered to further improve the hearing of speech and spoken dialog by boosting not only vocal frequency range, but also better amplification of surrounding sound beyond the conventional transparency mode.

Follow the steps below to further personalize the feature:

1. Pair Creative Sensemore Air to the Creative app by following the in-app instructions
2. Upon successful pairing, tap on the Noise Control module on the Creative app's dashboard
3. Tap and drag on the slider to adjust the level of ambient sound you'd like to let into the earbuds. Changes made will be saved and applied in real time

Ambient Mode

Let in just enough of ambient sound into the earbuds to be more aware of your surroundings and stay alert to what's happening around you without having to pause your songs.

The Creative Sensemore Air is set to Sensemore Mode by default. Follow the steps below to reassign the touch control:

1. Pair Creative Sensemore Air to the Creative app by following the in-app instructions. If you have already done so, proceed to step 2
2. Upon successful pairing, tap on the Noise Control module on the Creative app's dashboard and select Ambient Mode as your preferred mode
3. Tap and drag on the slider to adjust the level of ambient sound you'd like to let into the earbuds. Changes made will be saved and applied in real time

Active Noise Cancellation (ANC)

Stay focused and rid distractions with ANC, which cancels out ambient sound from your environment, creating the perfect seal in your ears while reducing unwanted background noises.

Follow the steps below to further personalize the feature:

1. Pair Creative Sensemore Air to the Creative app by following the in-app instructions. If you have already done so, proceed to step 2
2. Upon successful pairing, tap on the Noise Control module on the Creative app's dashboard and ensure that Active Noise Cancellation is selected
3. Tap and drag on the slider to adjust your preferred ANC level. Changes made will be saved and applied in real time

CREATIVE APP



Set up your product, customize playback controls, personalize audio settings, enhance the product's performance, and more with the Creative app.

- Choose between Sensemore Mode and Ambient Mode
- Customize buttons for personalized playback experience
- Adjust noise control level through Sensemore Mode, Ambient Mode, and Active Noise Cancellation
- Modify audio settings with Graphic EQ
- Perform software upgrades, product registration, and more

Download the Creative App from:



iOS App Store



Google Play Store

EARBUDS FIT GUIDE

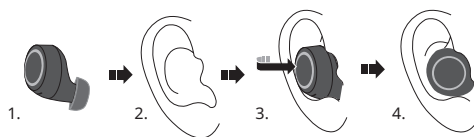

Gently push and wiggle the earbuds into the respective ear canal until a good seal is made to ensure proper fitting. Additional pairs of silicone tips are also provided so users can achieve an optimal fit.

CHARGING CREATIVE SENSEMORE AIR WIRELESSLY

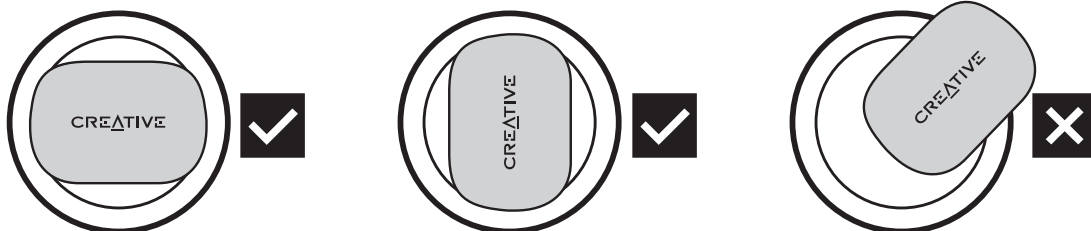

Creative Sensemore Air supports Qi-enabled wireless charging. To charge both the charging case and earbuds wirelessly, slot the earbuds into the case's magnetic charging slots, then place the charging case on the wireless charging pad*. Do note that the earbuds cannot be charged wirelessly without its charging case.

*Wireless charging pad not included

MASTER RESET

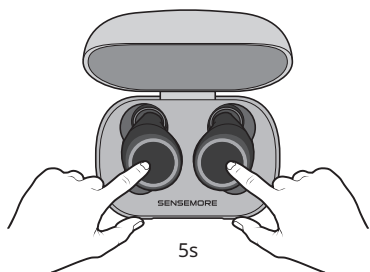

Touch the earbuds and hold for 5s while they are in the charging case. Earbuds will blink once in blue upon completion of Master Reset. Master Reset is reserved for cases where users encounter issues while earbuds are in use or during situations such as:

Bluetooth Pairing failure, random LED blinking, failure to pair secondary earbud with the main earbud, or to reset all data.

Common Connectivity Issues

This article highlights a phenomena and recommendation for music cutting out and earbuds that do not stay connected.

When pairing a smart mobile device with the earbuds, the signal is strongest when there is a line-of-sight between the pairing devices.

If the signal passes through the body, which is mostly made up of water fluid, it may get absorbed, which may result in pairing difficulty. If the mobile device is already connected to the earbuds, it may result in signal lost or the earbuds may get disconnected.

Preventing Oscillating Whistling Noise

When Sensemore Mode or Ambient Mode is enabled, there is a possibility of an oscillating whistling sound produced by the earbuds when the built-in microphones are blocked or while it's being held in the palm of your hand. It may also occur when the earbuds are kept away without its charging case in an enclosed area or through humid conditions and / or perspiration.

To prevent this occurrence,

- Ensure the built-in microphones are not blocked by your palm or hand, and to keep the earbuds dry
- Turn off Sensemore Mode / Ambient Mode before placing the earbuds back in its charging case
- Reduce the level of Sensemore Mode / Ambient Mode via the Creative app
- Ensure that the charging case is adequately charged before placing the earbuds back in its charging case to charge

TECHNICAL SPECIFICATIONS

Headphones Drivers

- 6 mm Bio-cellulose Driver x 2
- Frequency Response: 20-20,000 Hz

Microphones

- Type: Omni-directional x 4
- Frequency Response: 100-10,000 Hz
- Sensitivity (1 kHz): -38 dBV / Pa

Interface

- Qi-compatible wireless charging, USB-C (charging)

Wireless Operating Range

- Up to 10m / 33 ft
- RF Output Power: < 8 dBm
- Operating Frequency: 2402-2480 MHz

Bluetooth Version

- Bluetooth 5.2

Bluetooth Profiles

- A2DP (Advanced Audio Distribution Profile)
- AVRCP (Audio / Video Remote Control Profile)
- HFP (Hands-free profile)

Battery

- **Earbuds (Left and Right)**
Lithium-ion polymer battery:
3.7V 60 mAh 0.222 Wh
- **Battery Charging Case**
Lithium-ion polymer battery:
3.7V 400 mAh 1.48 Wh

Input Rating

- 5V = 1A

Total Playtime

- Up to 35 hours

Charging Time

- 2-3 hours

Audio Codecs

- AAC, SBC

Sweat & Water Resistance for Earbuds

- IPX5

Operating Temperature

- 0-45°C

Obsah je uzamčen

Dokončete, prosím, proces objednávky.

Následně budete mít přístup k celému dokumentu.



Proč je dokument uzamčen? Nahněvat Vás rozhodně nechceme. Jsou k tomu dva hlavní důvody:

- 1) Vytvořit a udržovat obsáhlou databázi návodů stojí nejen spoustu úsilí a času, ale i finanční prostředky. Dělali byste to Vy zadarmo? Ne*. Zakoupením této služby obdržíte úplný návod a podpoříte provoz a rozvoj našich stránek. Třeba se Vám to bude ještě někdy hodit.

**) Možná zpočátku ano. Ale vězte, že dotovat to dlouhodobě nelze. A rozhodně na tom nezbohatneme.*

- 2) Pak jsou tady „roboti“, kteří se přiživují na naší práci a „vysávají“ výsledky našeho úsilí pro svůj prospěch. Tímto krokem se jim to snažíme překazit.

A pokud nemáte zájem, respektujeme to. Urgujte svého prodejce. A když neuspějete, rádi Vás uvidíme!