

KENWOOD

SB050 series

instructions
istruzioni
instrucciones
Bedienungsanleitungen
gebruiksaanwijzing



smoothie
2GO

English	2 - 6
Nederlands	7 - 12
Français	13 - 18
Deutsch	19 - 24
Italiano	25 - 30
Português	31 - 36
Español	37 - 42
Dansk	43 - 47
Svenska	48 - 52
Norsk	53 - 57
Suomi	58 - 62
Türkçe	63 - 68
Česky	69 - 74
Magyar	75 - 80
Polski	81 - 86
Русский	87 - 93
Ελληνικά	94 - 100
عربي	١٠٥ - ١٠١



HEAD OFFICE: Kenwood Limited, 1-3 Kenwood Business Park, New Lane, Havant, Hampshire PO9 2NH

kenwoodworld.com

KENWOOD
CREATE MORE

18843/3



English

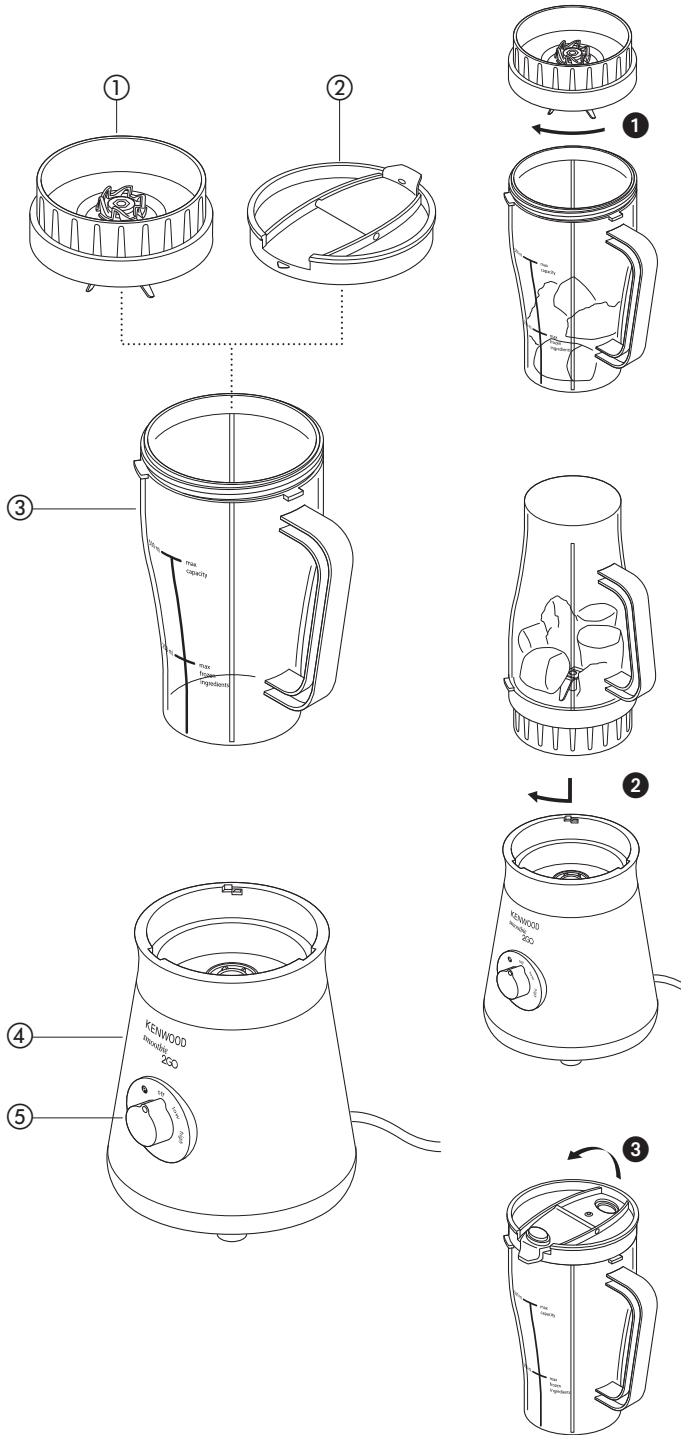

You can use your Smoothie Blender for making delicious and nutritious cold drinks. The dispensing lid means that the goblet can easily be converted into a travel mug.

A selection of recipes can be found at the back of the instructions, and the handy markings on the mug allow you to mix ingredients of your choice. Combinations of fruit and yoghurt (both fresh and frozen), ice cream, ice cubes, juice and milk can be used.

before using your Kenwood appliance

- Read these instructions carefully and retain for future reference.
- Remove all packaging and any labels.
- Wash the parts: see 'care & cleaning'.

safety

- Switch off and unplug:
 - before fitting and removing parts
 - after use
 - before cleaning.
- Never let the power unit, cord or plug get wet.
- Never use a damaged machine. Get it checked or repaired: see 'service'.
- Never use an unauthorised attachment.
- Never leave the appliance on unattended.
- Always wait until the blades have completely stopped before removing the mug from the power unit.
- The unit may also be used for making soups but only blend cold ingredients.
- Never blend hot ingredients or drink any hot liquids from the travel mug.

- When drinking through the lid, take care that the drink is smooth. Some experimentation may be necessary to achieve the desired result, particularly when processing firm or unripened foods as you may find that some ingredients remain unprocessed.
- Always take care when handling the blade assembly and avoid touching the cutting edge of the blades when cleaning.
- Only use the Smoothie Blender with the blade assembly supplied.
- Always use the Smoothie Blender on a secure, dry level surface.
- Never place the appliance on or near a hot gas or electric burner or where it could come into contact with a heated appliance.
- Misuse of your Smoothie Blender can result in injury.
- This appliance is not intended for use by persons (including children) with reduced physical, sensory or mental capabilities, or lack of experience and knowledge, unless they have been given supervision or instruction concerning use of the appliance by a person responsible for their safety.
- Children should be supervised to ensure that they do not play with the appliance.
- Only use the appliance for its intended domestic use. Kenwood will not accept any liability if the appliance is subject to improper use, or failure to comply with these instructions.

before plugging in

- Make sure your electricity supply is the same as the one shown on the underside of the appliance.
- This appliance conforms to EC directive 2004/108/EC on Electromagnetic Compatibility and EC regulation no. 1935/2004 of 27/10/2004 on materials intended for contact with food.

key

- ① blade assembly
- ② dispensing lid x 2
- ③ travel mug x 2
- ④ power unit
- ⑤ speed control

to use your smoothie blender

- 1 Add ice or frozen ingredients to the mug ①.
 - This includes frozen fruit, frozen yoghurt, ice cream or ice. These can be added **up to** the level marked 'max frozen ingredients'.
- 2 Add liquid ingredients to the mug.
 - This includes fruit (not frozen), fresh yoghurt, milk and fruit juices. These can be placed into the mug to the level marked 'max capacity'.
- 3 Hold the underside of the blade unit and lower it onto the mug, blades down – turn clockwise to lock ①.
- 4 Shake to disperse the ingredients.
- 5 To fit the assembled mug to the power unit, turn the mug upside down and line up the tabs on the mug with the grooves in the power unit and then turn clockwise until a positive click is heard ②.
- 6 Select the required speed.
 - When blending recipes that include frozen ingredients turn the speed control to 'low' for 5 seconds to start the mixing process, then turn the speed control to 'high'.
 - Allow the ingredients to blend until smooth.
- 7 When the desired consistency is reached, turn the speed control to the 'off' position. Turn the mug anticlockwise to release it from the power unit.
- 8 Turn the mug the other way up and unscrew the blade assembly.
- 9 Fit and lock the lid by turning clockwise.
 - When you want to drink the smoothie, simply flip open the lid cover and clip into position ③. The drink can be consumed straight from the mug.

hints & tips

- Note that when the mug is filled to max capacity (500ml), this is approximately two servings.
- If you don't intend to consume your smoothie drink immediately, keep it refrigerated.
- Ensure your smoothie drink is thin enough to be able to drink from the dispensing lid. To make a thinner smoothie drink add more liquid.
- Once your smoothie drink has reached the desired consistency, you can use the pulse 'P' to ensure all ingredients are thoroughly blended. Use the pulse 'P' to operate the power unit in a start stop action to control the texture of your drink.
- After blending, some drinks may not be completely smooth due to seeds or the fibrous nature of ingredients.
- Some drinks may separate on standing, therefore it's best to drink them straight away. Separated drinks should be stirred before drinking.

important

- Never blend dry ingredients (eg spices, nuts) or run the Smoothie Blender empty.
- Don't use the Smoothie Blender as a storage container whilst on the power unit.
- Some liquids increase in volume and froth during blending e.g milk, so do not overfill and ensure the blade assembly is correctly fitted.
- To ensure long life of your Smoothie Blender, never run it continuously for longer than 30 seconds.
- Never blend food that has formed a solid mass during freezing, break it up before adding to the mug.
- Never blend more than the max capacities marked on the mug.
- When the dispensing lid is fitted always keep the travel mug upright.

Obsah je uzamčen

Dokončete, prosím, proces objednávky.

Následně budete mít přístup k celému dokumentu.



Proč je dokument uzamčen? Nahněvat Vás rozhodně nechceme. Jsou k tomu dva hlavní důvody:

1) Vytvořit a udržovat obsáhlou databázi návodů stojí nejen spoustu úsilí a času, ale i finanční prostředky. Dělali byste to Vy zadarmo? Ne*. Zakoupením této služby obdržíte úplný návod a podpoříte provoz a rozvoj našich stránek. Třeba se Vám to bude ještě někdy hodit.

**) Možná zpočátku ano. Ale vězte, že dotovat to dlouhodobě nelze. A rozhodně na tom nezbohatneme.*

2) Pak jsou tady „roboti“, kteří se přiživují na naší práci a „vysávají“ výsledky našeho úsilí pro svůj prospěch. Tímto krokem se jim to snažíme překazit.

A pokud nemáte zájem, respektujeme to. Urgujte svého prodejce. A když neuspějete, rádi Vás uvidíme!