



Russell Hobbs



instructions

£10,000 prize draw
EXTRA year guarantee
FREE rewards gallery
www.russellhobbs.co.uk/productregister/
Register online now!
See back for details

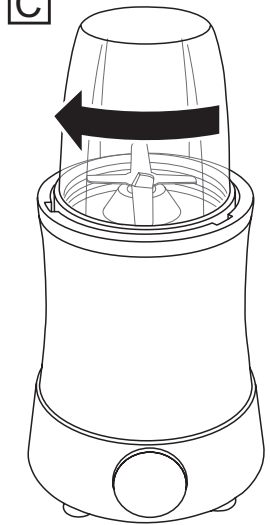
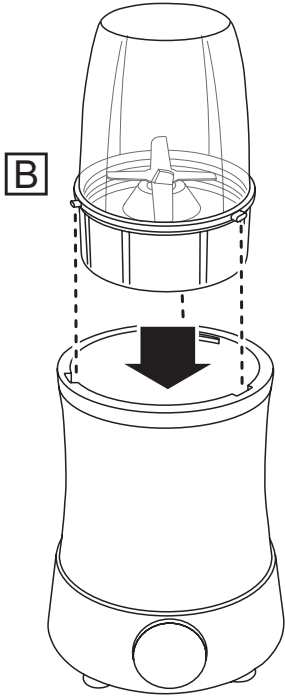
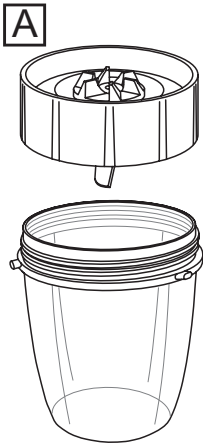
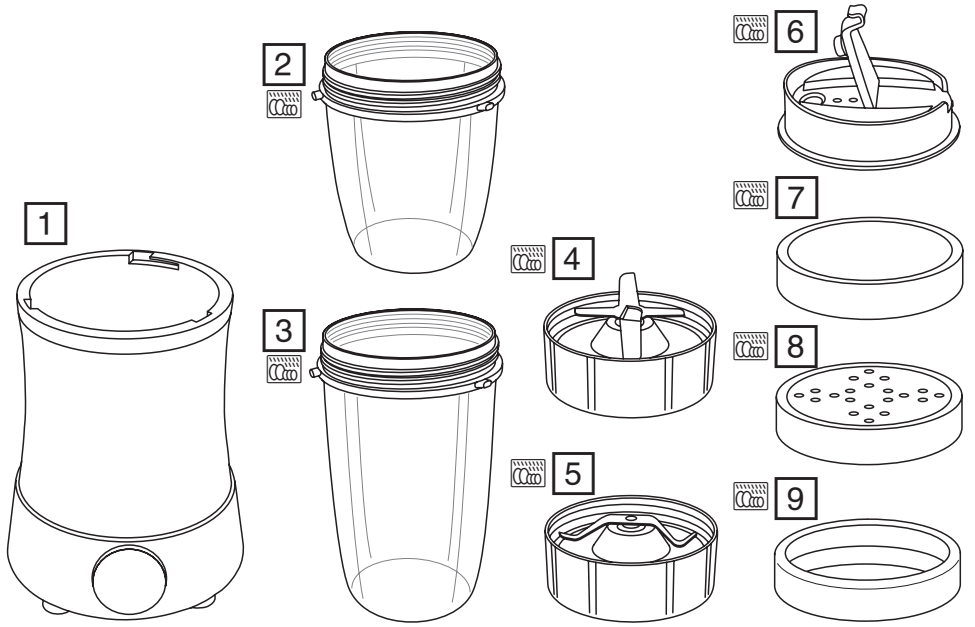

Read the instructions, keep them safe, pass them on if you pass the appliance on.
Remove all packaging before use.

IMPORTANT SAFEGUARDS

Follow basic safety precautions, including:

This appliance can be used by persons with reduced physical, sensory or mental capabilities or lack of experience and knowledge if they have been supervised/instructed and understand the hazards involved.

Children must not use or play with the appliance. Keep the appliance and cable out of reach of children.

Always disconnect the appliance from the mains supply socket if it is left unattended and before assembling, disassembling or cleaning.

Care must be taken when handling sharp cutting blades during emptying and cleaning.

Misuse of the appliance may cause injury.

Never process hot or boiling liquids. Allow them to cool before processing.

If the cable is damaged, it must be replaced by the manufacturer, its service agent, or someone similarly qualified, to avoid hazard.

- Don't put the motor unit in liquid.
- Don't use the appliance for any purpose other than those described in these instructions.
- Don't use accessories or attachments other than those we supply.
- Don't operate the appliance if it's damaged or malfunctions.
- Don't run the motor continuously for more than 1 minute, it may overheat. After 1 minute switch off and allow the appliance to rest for at least 1 minute.

HOUSEHOLD USE ONLY

PARTS

- | | |
|----------------------------|---|
| 1. Motor unit | 6. Travel lid with spout (x2) |
| 2. Small cup (x2) | 7. Solid lid (x2) |
| 3. Large cup (x3) | 8. Shaker lid |
| 4. 6-point blending blade | 9. Lip ring (x2) |
| 5. Serrated grinding blade |  dishwasher safe |

BEFORE USING FOR THE FIRST TIME

- Remove any packaging material and labels.
- Wash everything except the motor unit in warm, soapy water. Rinse and dry.
- Wipe the motor unit with a damp cloth.
- Place the appliance on a dry, firm, level surface, near a power socket.

BLADES

6-point blending blade - suitable for blending smoothies, soups, sauces, purées, etc.

Serrated grinding blade - suitable for grinding harder ingredients like coffee beans, nuts, chocolate, spices, etc.

Obsah je uzamčen

Dokončete, prosím, proces objednávky.

Následně budete mít přístup k celému dokumentu.



Proč je dokument uzamčen? Nahněvat Vás rozhodně nechceme. Jsou k tomu dva hlavní důvody:

- 1) Vytvořit a udržovat obsáhlou databázi návodů stojí nejen spoustu úsilí a času, ale i finanční prostředky. Dělali byste to Vy zadarmo? Ne*. Zakoupením této služby obdržíte úplný návod a podpoříte provoz a rozvoj našich stránek. Třeba se Vám to bude ještě někdy hodit.

**) Možná zpočátku ano. Ale vězte, že dotovat to dlouhodobě nelze. A rozhodně na tom nezbohatneme.*

- 2) Pak jsou tady „roboti“, kteří se přiživují na naší práci a „vysávají“ výsledky našeho úsilí pro svůj prospěch. Tímto krokem se jim to snažíme překazit.

A pokud nemáte zájem, respektujeme to. Urgujte svého prodejce. A když neuspějete, rádi Vás uvidíme!