

# Oral-B®

VITALITY powered by BRAUN

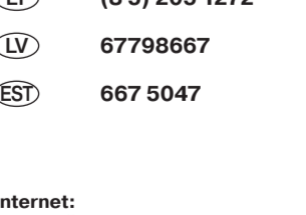

Type 3757

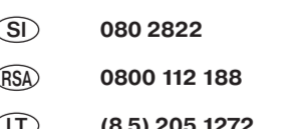
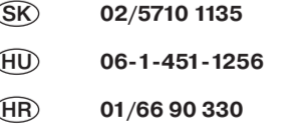
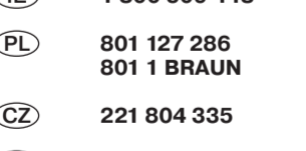
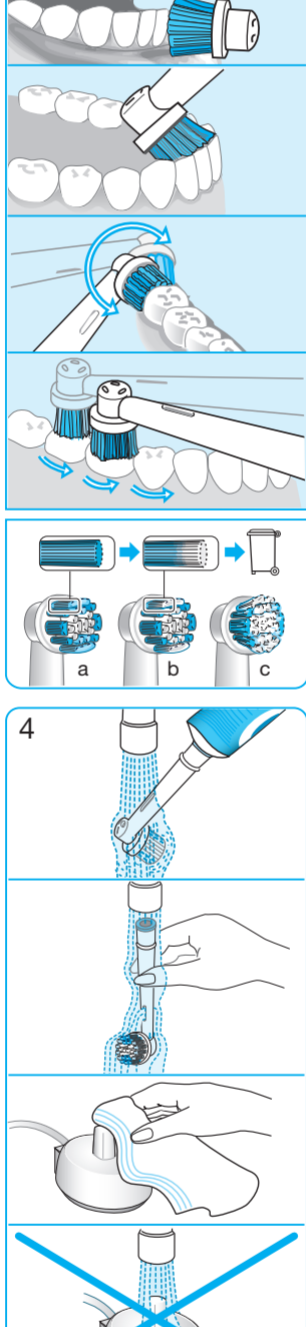
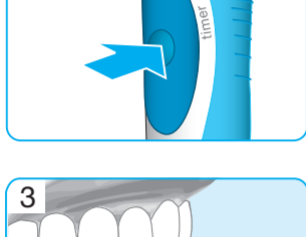
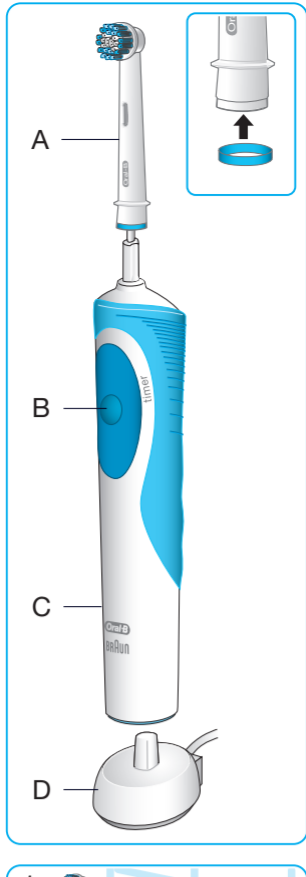

- (GB)** 0 800 783 7010
- (IE)** 1 800 509 448
- (PL)** 801 127 286  
801 1 BRAUN
- (CZ)** 221 804 335
- (SK)** 02/5710 1135
- (HU)** 06-1-451-1256
- (HR)** 01/66 90 330
- (SI)** 080 2822
- (RSA)** 0800 112 188
- (LT)** (8 5) 205 1272
- (LV)** 67798667
- (EST)** 667 5047

**Internet:**  
[www.oralb.com](http://www.oralb.com)  
[www.braun.com](http://www.braun.com)  
[www.service.braun.com](http://www.service.braun.com)

Braun GmbH  
 Frankfurter Straße 145  
 61476 Kronberg/Germany

**Charger Type 3757**  
**Handle Type 3709**

96865278/XI-14  
 GB/PL/CZ/SK/H/HR/SLO/LT/LV/EST

## English

Welcome to Oral-B.

Please read the use instructions carefully before first use.

### IMPORTANT

- Periodically check the cord for damage. If cord is damaged, take the charging unit to an Oral-B Service Centre. A damaged or non-functioning unit should no longer be used. Do not modify or repair the product. This may cause fire, electric shock or injury.
- This product is not intended for use by children under age three. Children from 3 to 14 years and persons with reduced physical, sensory or mental capabilities or lack of experience and knowledge can use the toothbrush, if they have been given supervision or instruction concerning use of the appliance in a safe way and understand the hazards involved.
- Cleaning and maintenance shall not be performed by children.
- Children shall not play with the appliance.
- Use this product only for its intended use as described in this manual. Do not use attachments which are not recommended by the manufacturer.

### WARNING

- If the product is dropped, the brush head should be replaced before the next use even if no damage is visible.
- Do not place the charger in water, liquid or store it where it can fall or be pulled into a tub or sink. Do not reach for it if it has fallen into water. Unplug immediately.
- Do not disassemble the product except when disposing of the battery. When taking out the battery for disposal of the unit, use caution not to short the positive (+) and negative (-) terminals.
- When unplugging, always hold the power plug instead of the cord. Do not touch the power plug with wet hands. This can cause an electric shock.
- If you are undergoing treatment for any oral care condition, consult your dental professional prior to use.
- This toothbrush is a personal care device and not intended for use on multiple patients in a dental practice or institution.

### Description

A Brush head

B On/off switch

C Handle

D Charging unit

#### Specifications:

Noise level: ≤65 dB(A)

For voltage specifications please refer to the bottom of the charging unit.

### Connecting and charging

Your toothbrush has a waterproof handle, is electrically safe and designed for use in the bathroom.

- Plug the charging unit (D) into an electrical outlet and place the toothbrush handle (C) on the charging unit. A full charge takes about 16 hours and enables up to five days of regular brushing (twice a day, 2 minutes) (1).

- For everyday use, the toothbrush handle can be stored on the plugged-in charging unit to maintain it at full power. Overcharging is impossible.

### Battery maintenance

To maintain the maximum capacity of the rechargeable battery, unplug the charging unit and discharge the handle by regular use at least every 6 months.

### Using the toothbrush

#### Brushing technique

Wet brush head and apply any kind of toothpaste. To avoid splashing, guide the brush head to your teeth before switching on the appliance (B) (2). When brushing your teeth with one of the **Oral-B oscillating-rotating brush heads** guide the brush head slowly from tooth to tooth, spending a few seconds on each tooth surface.

When using the **Oral-B «TriZone» brush head** place the toothbrush bristles against the teeth at a slight angle towards the gumline. Apply light pressure and start brushing in back and forth motions, just like you would do with a manual toothbrush.

With any brush head start brushing the outsides, then the insides and finally the chewing surfaces. Brush all four quadrants of your mouth equally. Do not press too hard, simply let the brush do all the work.

You may also consult your dentist or dental hygienist about the right technique for you (3).

#### Timer (depending on model)

An incorporated timer memorises the elapsed brushing time. A short stuttering sound indicates the end of the professionally recommended 2-minute brushing time.

### Brush heads

Oral-B offers you a variety of different Oral-B brush heads that fit your Oral-B toothbrush handle.

#### The Oral-B Precision Clean brush head



cups each tooth with a curved bristle trim and reaches deep between teeth at the same time.

#### The Oral-B Sensitive brush head



an extra soft bristle texture that is gentle on teeth and gums.

#### Oral-B 3DWhite brush head



features a dentist-inspired polishing cup to remove surface stains from coffee, tea and

# Obsah je uzamčen

**Dokončete, prosím, proces objednávky.**

**Následně budete mít přístup k celému dokumentu.**



**Proč je dokument uzamčen? Nahněvat Vás rozhodně nechceme. Jsou k tomu dva hlavní důvody:**

- 1) Vytvořit a udržovat obsáhlou databázi návodů stojí nejen spoustu úsilí a času, ale i finanční prostředky. Dělali byste to Vy zadarmo? Ne\*. Zakoupením této služby obdržíte úplný návod a podpoříte provoz a rozvoj našich stránek. Třeba se Vám to bude ještě někdy hodit.

*\*) Možná zpočátku ano. Ale vězte, že dotovat to dlouhodobě nelze. A rozhodně na tom nezbohatneme.*

- 2) Pak jsou tady „roboti“, kteří se přiživují na naší práci a „vysávají“ výsledky našeho úsilí pro svůj prospěch. Tímto krokem se jim to snažíme překazit.

A pokud nemáte zájem, respektujeme to. Urgujte svého prodejce. A když neuspějete, rádi Vás uvidíme!