

KENWOOD

JKP250

instructions
istruzioni
instrucciones
Bedienungsanleitungen
gebruiksaanwijzing

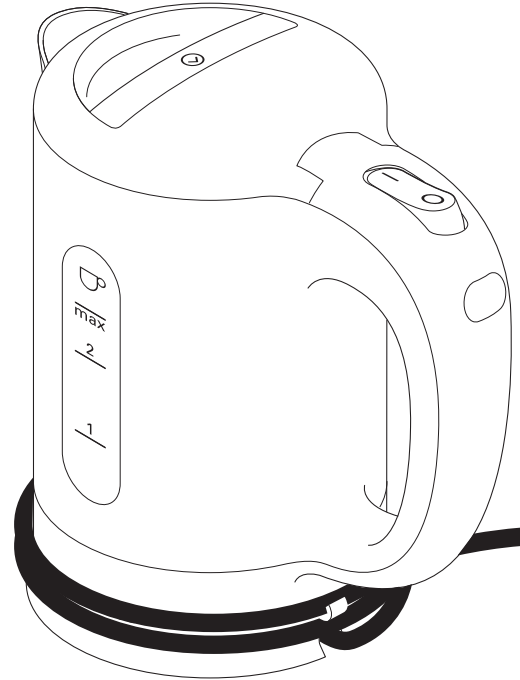

English	2 - 5
Nederlands	6 - 10
Français	11 - 15
Deutsch	16 - 20
Italiano	21 - 25
Português	26 - 29
Español	30 - 34
Dansk	35 - 38
Svenska	39 - 42
Norsk	43 - 46
Suomi	47 - 50
Türkçe	51 - 54
Česky	55 - 58
Magyar	59 - 63
Polski	64 - 68
Русский	69 - 73
Ελληνικά	74 - 78
Slovenčina	79 - 83
Українська	84 - 88
عربي	٩٢ - ٨٩



HEAD OFFICE: Kenwood Limited, 1-3 Kenwood Business Park, New Lane, Havant, Hampshire PO9 2NH

kenwoodworld.com

KENWOOD
CREATE MORE

40781/1



English

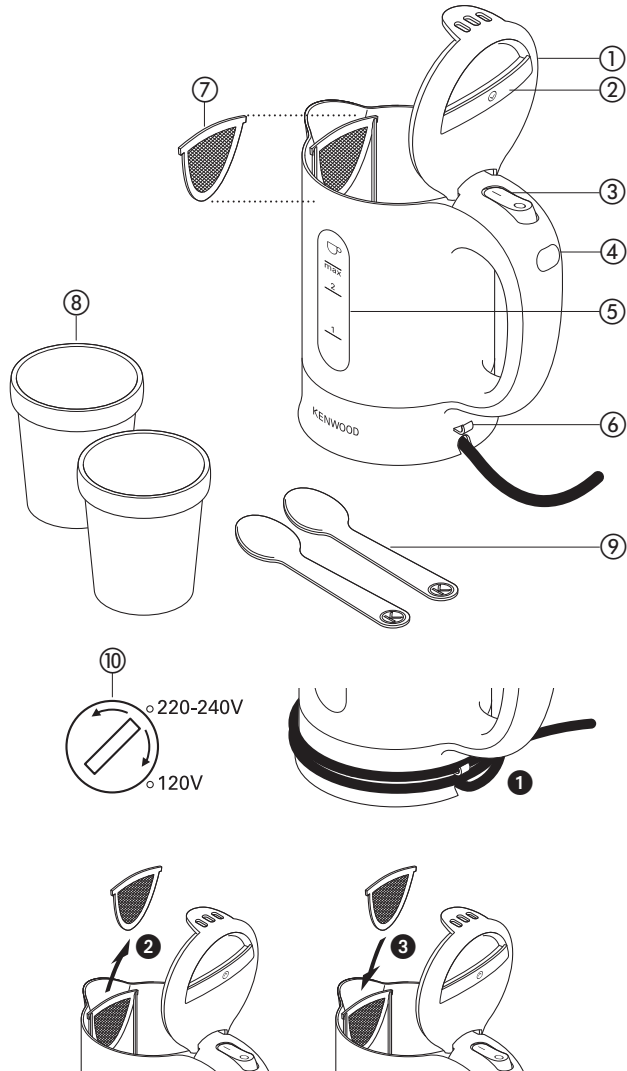

before using your Kenwood appliance

- Read these instructions carefully and retain for future reference.
- Remove all packaging and any labels.

safety

- **Your kettle has a dual voltage selector ⑩ on the underside of the kettle. Always check that you have selected the correct voltage before using the kettle.**

- Always use the filter and never overfill - boiling water may splash out.
- Avoid contact with steam coming out of the spout area when pouring and out of the lid or spout area when refilling.
- Never let the cord hang down where a child could grab it.
- **Always unplug your kettle when not in use.**
- Never put the kettle, cord or plug in liquid.
- Never use a damaged appliance. Get it checked or repaired: see 'service and customer care'.
- **Caution:** Do not operate the kettle on an inclined surface.
- Make sure the lid is secure before switching the kettle on.
- **Warning:** Do not open the lid while the water is boiling.
- Take care when opening the lid - droplets of hot water may be ejected.
- Make sure the kettle is switched off before lifting or pouring.
- Unplug the kettle before filling or pouring.
- Never put the kettle near or on cooker hot plates or gas burners.
- This kettle is for boiling water only.
- This appliance is not intended for use by persons (including children) with reduced physical, sensory or mental capabilities, or lack of experience and knowledge, unless they have been given supervision or instruction concerning use of the appliance by a person responsible for their safety.
- Children should be supervised to ensure that they do not play with the appliance.
- Only use the appliance for its intended domestic use. Kenwood will not accept any liability if the appliance is subject to improper use, or failure to comply with these instructions.

before plugging in

- Make sure your electricity supply is the same as the one shown on the underside of your kettle. The JKP250 travel kettle is of class 1 construction and should only be used in an EARTHED socket. Any travel plug adapter used MUST provide an earth connection.

- This appliance conforms to EC directive 2004/108/EC on Electromagnetic Compatibility and EC regulation no. 1935/2004 of 27/10/2004 on materials intended for contact with food.

before using for the first time

- Remove the cups and spoons from the kettle.
- Fill to 'MAX', boil, then pour the water away. Repeat 2 to 3 times.
- Wash the cups and spoons and then dry.

key

- ① hinged lid
- ② lid release catch
- ③ on/off switch
- ④ indicator light
- ⑤ water level windows
- ⑥ cord clip
- ⑦ filter
- ⑧ 2 cups
- ⑨ 2 spoons
- ⑩ dual voltage selector

to use your travel jug kettle

- 1 Remove the cups and spoons from the kettle.
- 2 Select the required voltage by turning the selector control ⑩. **Always check that you have selected the correct voltage before using the kettle.**

- 3 Fill the kettle through either the spout or lid. To open the lid, pull back the lid release catch ②. The water level must be between 'MAX' and 1 cup (200mls).

- Be economical: do not boil more water than you need.
 - To improve the quality of your drinks always use fresh water.
 - Empty the kettle after each use.
- 4 Check the lid is closed.
 - 5 Plug in and switch on. The indicator light ④ will come on.

- 6 Your kettle will boil and switch off automatically. To re-boil, wait a few seconds - the on/off switch needs time to reset.

- **If you experience problems with your kettle switching on and off during use or switching off before boiling, check that the flat element is free from scale - see "descaling".**

- Take care when using the cups and do not overfill above the inner rim (approx. 200mls).
- Your kettle is fitted with a filter to hold back limescale particles.
- If you find drops of water under your kettle, don't worry - it is just condensation.

boil-dry protection

- If you switch on with too little water, your kettle will cut out automatically. Switch off, unplug and let it cool down before re-filling. When it has cooled down, the switch will reset itself.

Obsah je uzamčen

Dokončete, prosím, proces objednávky.

Následně budete mít přístup k celému dokumentu.



Proč je dokument uzamčen? Nahněvat Vás rozhodně nechceme. Jsou k tomu dva hlavní důvody:

- 1) Vytvořit a udržovat obsáhlou databázi návodů stojí nejen spoustu úsilí a času, ale i finanční prostředky. Dělali byste to Vy zadarmo? Ne*. Zakoupením této služby obdržíte úplný návod a podpoříte provoz a rozvoj našich stránek. Třeba se Vám to bude ještě někdy hodit.

**) Možná zpočátku ano. Ale vězte, že dotovat to dlouhodobě nelze. A rozhodně na tom nezbohatneme.*

- 2) Pak jsou tady „roboti“, kteří se přiživují na naší práci a „vysávají“ výsledky našeho úsilí pro svůj prospěch. Tímto krokem se jim to snažíme překazit.

A pokud nemáte zájem, respektujeme to. Urgujte svého prodejce. A když neuspějete, rádi Vás uvidíme!