

# KENWOOD

Type BLP60, BLP61  
Type BLM60, BLM61

instructions

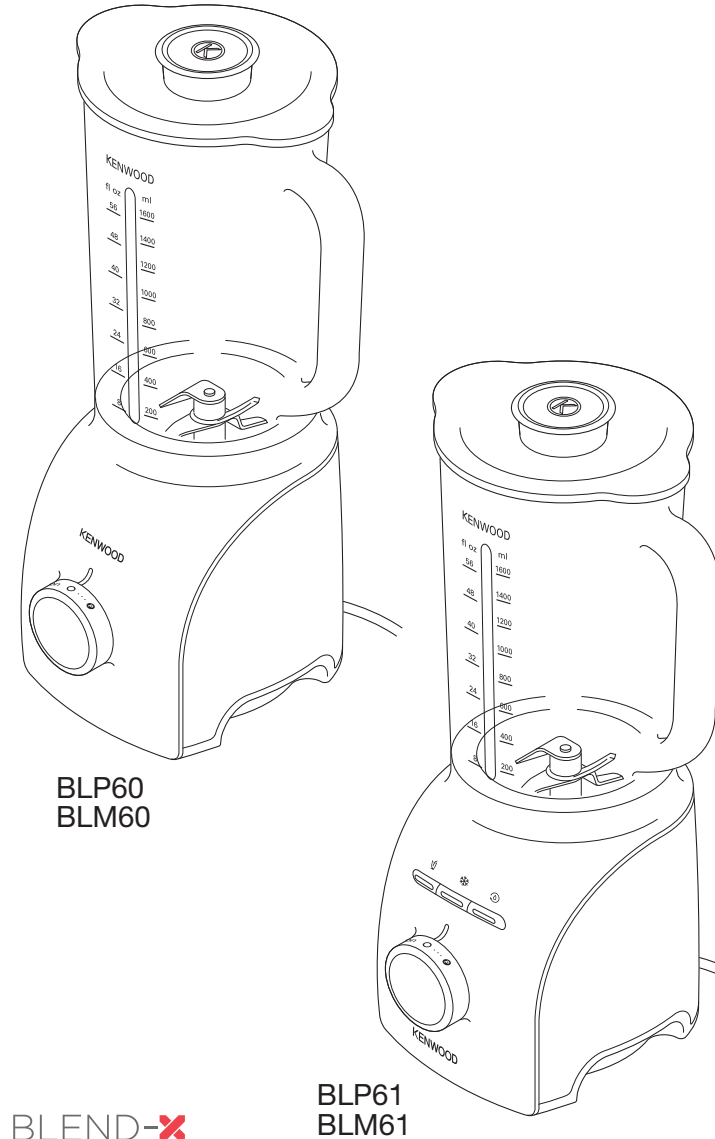

English	2 - 12
Nederlands	13 - 24
Français	25 - 37
Deutsch	38 - 50
Italiano	51 - 62
Português	63 - 75
Español	76 - 88
Dansk	89 - 99
Svenska	100 - 110
Norsk	111 - 121
Suomi	122 - 132
Türkçe	133 - 144
Česky	145 - 156
Magyar	157 - 169
Polski	170 - 183
Ελληνικά	184 - 197
Slovenčina	198 - 210
Українська	211 - 224
عربي	٢٢٦ - ٢٢٥



HEAD OFFICE: Kenwood Limited, 1-3 Kenwood Business Park, New Lane, Havant, Hampshire PO9 2NH

[kenwoodworld.com](http://kenwoodworld.com)

**KENWOOD**  
CREATE MORE

126673/1

BLEND-~~X~~  
CLASSIC

BLP61  
BLM61



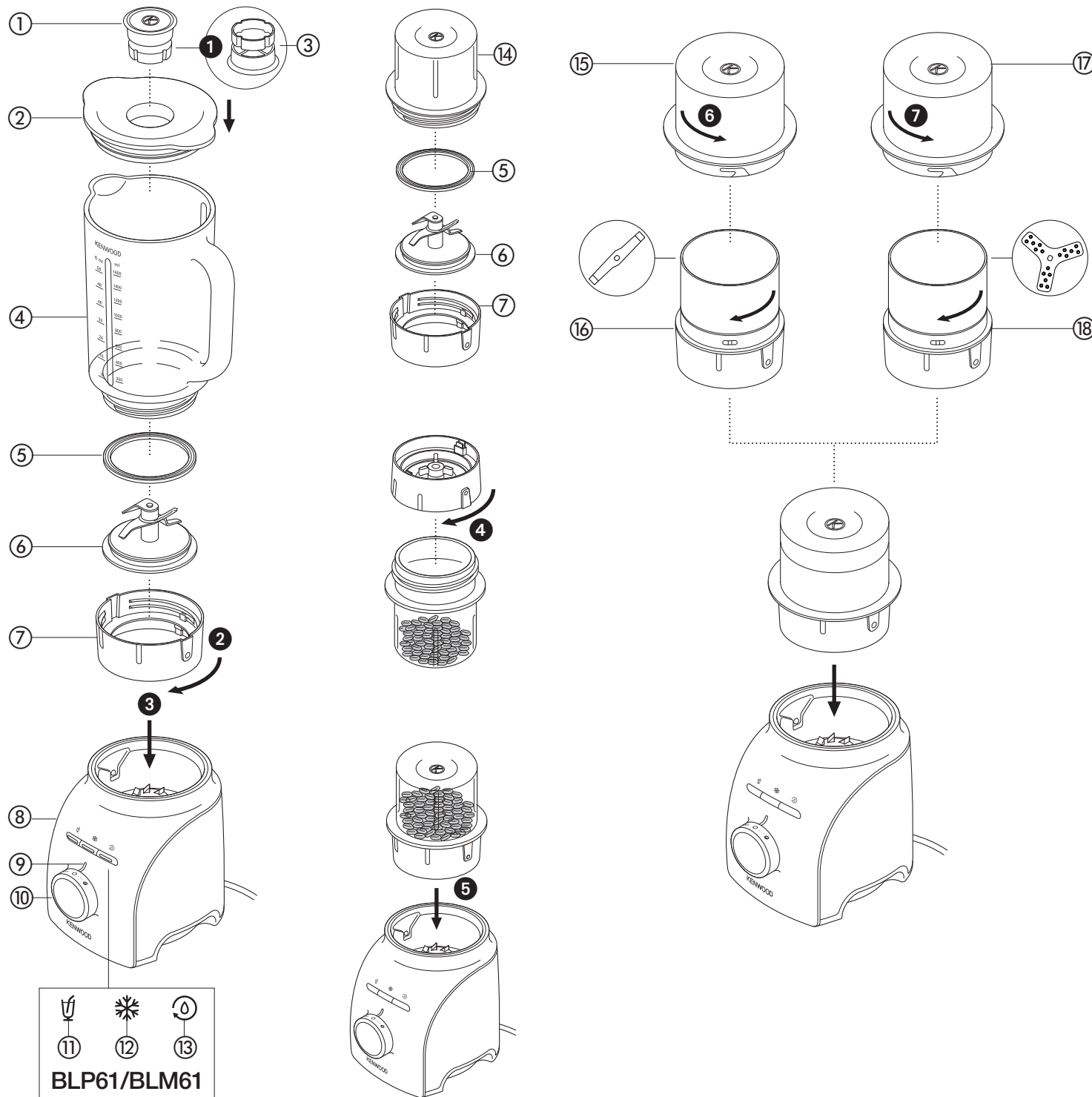

## safety

- Read these instructions carefully and retain for future reference.
- Remove all packaging and any labels.
- Switch off and unplug:
  - before fitting or removing parts;
  - when not in use;
  - before cleaning.
- **Never fit the blade unit to the power unit without the blender goblet or mill jar fitted.**
- Always unplug the appliance before putting your hands or utensils in the goblet.
- Always take care when handling the blade assembly and avoid touching the cutting edge of the blades when cleaning.
- Only operate the blender with the lid in place.
- Only use the goblet with the blade assembly supplied.
- Never let the power unit, cord or plug get wet.
- Never use a damaged appliance. Get it checked or repaired: see 'service and customer care'.
- Never use an unauthorised attachment.
- **SCALD RISK:** Hot ingredients should be allowed to cool to room temperature before blending.
- Never leave the appliance unattended when it is operating.
- When removing the blender or mill from the power unit:
  - wait until the blades have completely stopped;
  - don't accidentally unscrew the goblet or mill jar/lid from the blade assembly.

- Never run the blender empty.
- Never blend more than the maximum capacity stated in the recommended usage chart.
- To ensure long life of your blender or mill, do not run it continuously for longer than 60 seconds.
- Smoothie recipes - never blend frozen ingredients that have formed a solid mass during freezing, break it up before adding to the goblet.
- Do not process hard spices such as Nutmeg or Turmeric root as they may damage the blade.
- Do not use the blender as a storage container. Keep it empty before and after use.
- Always use the blender on a secure, dry level surface.
- Never place this appliance on or near a hot gas or electric burner or where it could touch a heated appliance.
- This appliance shall not be used by children. Keep the appliance and its cord out of reach of children.
- Misuse of your blender can result in injury.
- Appliances can be used by persons with reduced physical, sensory or mental capabilities or lack of experience and knowledge if they have been given supervision or instruction concerning use of the appliance in a safe way and if they understand the hazards involved.

# Obsah je uzamčen

**Dokončete, prosím, proces objednávky.**

**Následně budete mít přístup k celému dokumentu.**



**Proč je dokument uzamčen? Nahněvat Vás rozhodně nechceme. Jsou k tomu dva hlavní důvody:**

- 1) Vytvořit a udržovat obsáhlou databázi návodů stojí nejen spoustu úsilí a času, ale i finanční prostředky. Dělali byste to Vy zadarmo? Ne\*. Zakoupením této služby obdržíte úplný návod a podpoříte provoz a rozvoj našich stránek. Třeba se Vám to bude ještě někdy hodit.

*\*) Možná zpočátku ano. Ale vězte, že dotovat to dlouhodobě nelze. A rozhodně na tom nezbohatneme.*

- 2) Pak jsou tady „roboti“, kteří se přiživují na naší práci a „vysávají“ výsledky našeho úsilí pro svůj prospěch. Tímto krokem se jim to snažíme překazit.

A pokud nemáte zájem, respektujeme to. Urgujte svého prodejce. A když neuspějete, rádi Vás uvidíme!