

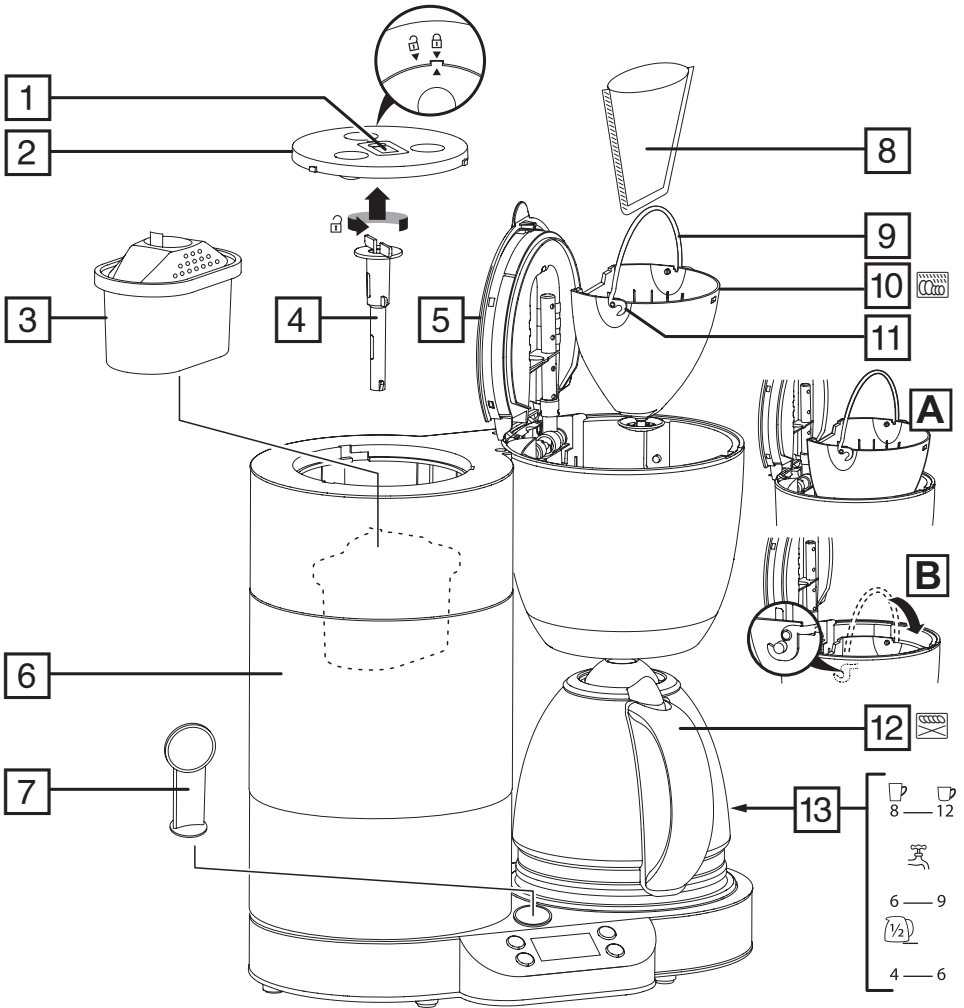

# Russell Hobbs



instructions	3	pokyny (Čeština)	55
Bedienungsanleitung	7	pokyny (Slovenčina)	59
mode d'emploi	13	instrukcja	63
instructies	17	upute	67
istruzioni per l'uso	21	navodila	71
instrucciones	27	οδηγίες	75
instruções	31	utasítások	81
brugsanvisning	35	talimatlar	85
bruksanvisning (Svenska)	39	instruções	89
bruksanvisning (Norsk)	43	инструкции (Български)	93
käyttöohjeet	47	تعليمات للاستخدام	99
инструкции (Русский)	51		



Read the instructions, keep them safe, pass them on if you pass the appliance on. Remove all packaging before use.

## IMPORTANT SAFEGUARDS

Follow basic safety precautions, including:

This appliance can be used by children aged from 8 years and above and persons with reduced physical, sensory or mental capabilities or lack of experience and knowledge if they have been given supervision or instruction concerning use of the appliance in a safe way and understand the hazards involved. Children shall not play with the appliance. Cleaning and user maintenance shall not be made by children unless they are older than 8 and supervised.

Keep the appliance and its cord out of reach of children less than 8 years old.

 Parts of the appliance are liable to get hot during use.

Don't immerse the appliance in liquid.

If the cable is damaged, return the appliance, to avoid hazard.

- Sit the appliance on a stable, level, heat-resistant surface.
- Keep the appliance and cable away from the edges of worktops.
- Don't use accessories or attachments other than those we supply.
- Don't use the appliance for any purpose other than those described in these instructions.
- Don't use the appliance if it's damaged or malfunctions.

## HOUSEHOLD USE ONLY

### DIAGRAM

- |                                   |                                   |
|-----------------------------------|-----------------------------------|
| 1. BRITA® Memo                    | 8. Paper filter #4 (not supplied) |
| 2. Water tank lid                 | 9. Filter handle                  |
| 3. BRITA® MAXTRA filter cartridge | 10. Filter holder                 |
| 4. Transit bolt                   | 11. Hook                          |
| 5. Filter compartment lid         | 12. Carafe                        |
| 6. Water tank                     | 13. Filling gauge                 |
| 7. Scoop                          |                                   |

### BRITA® MAXTRA FILTER CARTRIDGE

- The filter cartridge contains ion exchange resin and activated carbon.
- Reduces limescale and substances, eg. chlorine, that affect taste and odour.
- Reducing the impurities makes the water look and taste better, and the reduction in limescale helps your coffee machine too.
- Remember – water is a food, it goes off. Use filtered water within one day.

### BEFORE USING FOR THE FIRST TIME

1. Twist the water tank lid anticlockwise and remove.
2. Turn the red transit bolt anticlockwise and remove it.
3. Fill the reservoir by filling the carafe to  $\left(\frac{1}{2}\right)$  mark and pour into the reservoir twice and run the appliance without coffee.
4. Let it cool, discard the water, then use it normally.

# Obsah je uzamčen

**Dokončete, prosím, proces objednávky.**

**Následně budete mít přístup k celému dokumentu.**



**Proč je dokument uzamčen? Nahněvat Vás rozhodně nechceme. Jsou k tomu dva hlavní důvody:**

- 1) Vytvořit a udržovat obsáhlou databázi návodů stojí nejen spoustu úsilí a času, ale i finanční prostředky. Dělali byste to Vy zadarmo? Ne\*. Zakoupením této služby obdržíte úplný návod a podpoříte provoz a rozvoj našich stránek. Třeba se Vám to bude ještě někdy hodit.

*\*) Možná zpočátku ano. Ale vězte, že dotovat to dlouhodobě nelze. A rozhodně na tom nezbohatneme.*

- 2) Pak jsou tady „roboti“, kteří se přiživují na naší práci a „vysávají“ výsledky našeho úsilí pro svůj prospěch. Tímto krokem se jim to snažíme překazit.

A pokud nemáte zájem, respektujeme to. Urgujte svého prodejce. A když neuspějete, rádi Vás uvidíme!