



Visit us:  
[www.philips.com/welcome](http://www.philips.com/welcome)

© 2018 AquaShield  
All rights reserved.

The Philips trademark and the Philips Shield Emblem are registered trademarks of Koninklijke Philips N.V. used under license.

This product has been manufactured by and is sold under the responsibility of Hong Kong AquaShield Health Technology Company Limited and Hong Kong AquaShield Health Technology Company Limited is the warrantor in relation to this product.

Rev A OCT 19

**PHILIPS**

Water Solution

Shower Head

AWP1705



---

EN User manual 1

CS Návod k použití 4

DE Gebrauchsanleitung 7

ES Instrucciones de uso 10

FR Manuel d'utilisation 13

---

---

IT Manuale d'uso 16

PL Instrukcja użytkowania 19

RO Instrucțiuni de utilizare 22

RU Руководство по эксплуатации 25

---

## 1 Product Introduction

This product is mainly used for shower filtration. Municipal tap water is used as water supply. It does not need door-to-door installation. Please install it according to this user manual.

## 2 Installation

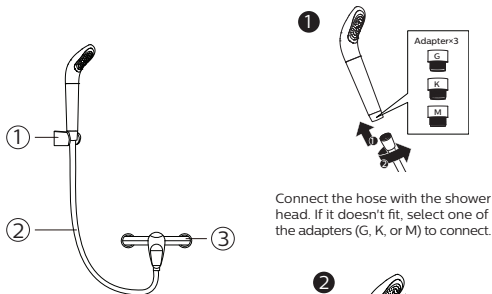

Connect the hose with the shower head. If it doesn't fit, select one of the adapters (G, K, or M) to connect.

- 1 Shower support
- 2 Shower hose (user-provided)
- 3 Hot & Cold water mixing valve

Turn on the tap for 1-2 minutes to check if there is any leakage.

## 3 Maintenance

- If the filter is not used for more than 3 days, let the water run 20 seconds before use again.
- If the filter is not used for more than a week, remove and drain the cartridge. Wrap and store it in the chiller of the fridge. Let the water run for 1 minute before use again.
- Replace the cartridge every 1 to 2 months based on the tap water quality and usage frequency. The model number is AWP106.

## 4 Precautions

- This product is for tap water only. Do not use water of unknown source.
- The pressure of the inlet water should be 0.15-0.35Mpa.
- The inlet water temperature should be 5-60°C, otherwise the cartridge will be damaged.
- The water treated by this product is for showering only. Do not drink the water filtered by it.
- The cartridge can only be cleaned with water. No detergents should be used because they will damage the filter.

## 5 Warranty

This product includes a 2-year warranty from the date of purchase. For more detail about warranty conditions, please visit: [www.Philips.com](http://www.Philips.com).

Within two years from the date of purchase, you will receive free warranty against defects in materials and workmanship, when used in compliance with the user manual and confirmed by our maintenance service.

The warranty service does not include frequent replaced consumable components (filter cartridge, granular activated carbon, ion exchange resin, hollow fiber membrane, etc.), auxiliary devices, transportation fee and door-to-door service.

Please show the proof of purchase to the service personnel during maintenance.

You cannot receive free warranty service under the following conditions:

1. Damage by improper operation, such as improper components connection, improper installation, deprived of manual use, misoperation.
2. Negligence and damage because of transportation or other accident.
3. Maintenance and modification without approval.
4. Other damage caused by force majeure (such as natural disaster, abnormal voltage, etc.).
5. Damage caused by general use outside home (e.g. industrial and commercial use).
6. Aging, wear and tear caused by normal operation of the product without affecting normal operation of the product.

This statement serves as a publicity for free maintenance within the specified time limit and conditions, and does not limit the legal rights of consumers.

## 6 Packing list

Shower head	1× incl. filter cartridge
Adapters (marked as G, K, and M)	1× for each
User manual	1×

Please keep this user manual properly for future reference.

## 1 Představení produktu

Tento produkt se používá především pro filtraci sprchy. Jako vodní zdroj se používá obecní voda z vodovodu. Není potřeba instalace u vás doma. Instalujte prosím podle tohoto návodu k použití.

## 2 Instalace

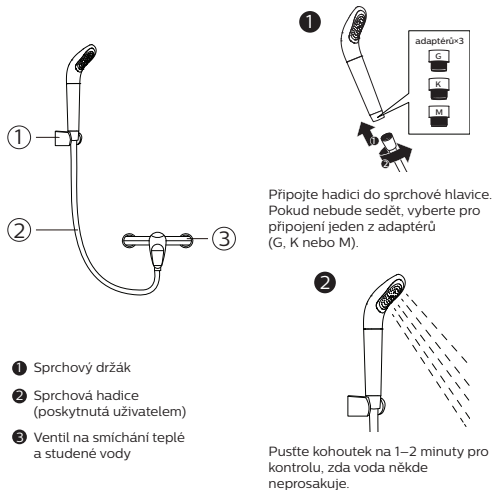

# Obsah je uzamčen

**Dokončete, prosím, proces objednávky.**

**Následně budete mít přístup k celému dokumentu.**



**Proč je dokument uzamčen? Nahněvat Vás rozhodně nechceme. Jsou k tomu dva hlavní důvody:**

- 1) Vytvořit a udržovat obsáhlou databázi návodů stojí nejen spoustu úsilí a času, ale i finanční prostředky. Dělali byste to Vy zadarmo? Ne\*. Zakoupením této služby obdržíte úplný návod a podpoříte provoz a rozvoj našich stránek. Třeba se Vám to bude ještě někdy hodit.

*\*) Možná zpočátku ano. Ale vězte, že dotovat to dlouhodobě nelze. A rozhodně na tom nezbohatneme.*

- 2) Pak jsou tady „roboti“, kteří se přiživují na naší práci a „vysávají“ výsledky našeho úsilí pro svůj prospěch. Tímto krokem se jim to snažíme překazit.

A pokud nemáte zájem, respektujeme to. Urgujte svého prodejce. A když neuspějete, rádi Vás uvidíme!