

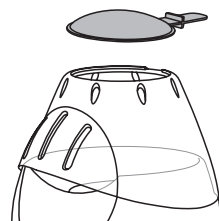

Russell Hobbs

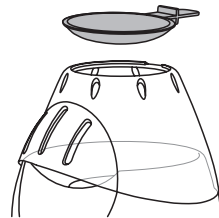

instructions	3	pokyny (Čeština)	27
Bedienungsanleitung	5	pokyny (Slovenčina)	29
mode d'emploi	7	instrukcja	31
instructies	9	upute	33
istruzioni per l'uso	11	navodila	35
instrucciones	13	οδηγίες	37
instruções	15	utasítások	39
brugsanvisning	17	talimatlar	41
bruksanvisning (Svenska)	19	instrucțiuni	43
bruksanvisning (Norsk)	21	инструкции (Български)	45
käyttöohjeet	23	تعليمات الاستخدام	47
инструкции (Русский)	25		

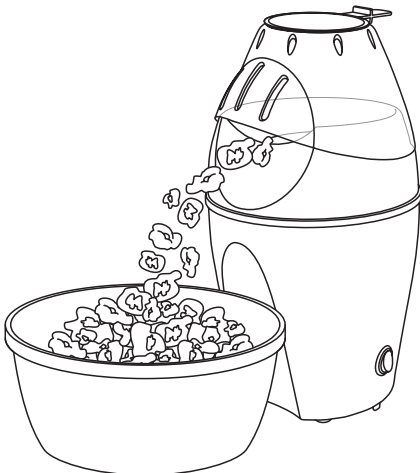
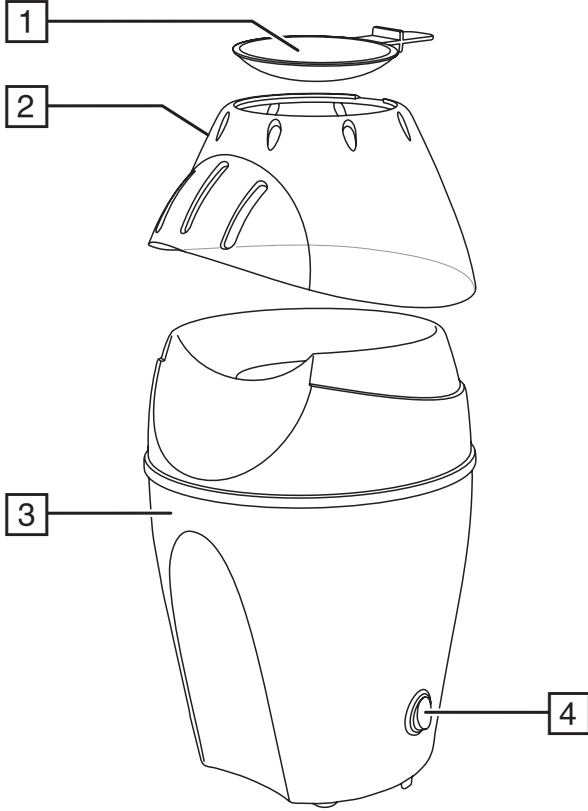

Read the instructions, keep them safe, pass them on if you pass the appliance on. Remove all packaging before use.

IMPORTANT SAFEGUARDS

Follow basic safety precautions, including:

This appliance can be used by children aged from 8 years and above and persons with reduced physical, sensory or mental capabilities or lack of experience and knowledge if they have been given supervision or instruction concerning use of the appliance in a safe way and understand the hazards involved. Children shall not play with the appliance. Cleaning and user maintenance shall not be done by children unless they are older than 8 and supervised.

Keep the appliance and its cord out of reach of children less than 8 years old.

Don't connect the appliance via a timer or remote control system.

Don't use the appliance near or below combustible materials such as curtains.

 The surfaces of the appliance will get hot during use.

If the cable is damaged, it must be replaced by the manufacturer, its service agent, or someone similarly qualified, to avoid hazard.

 Don't immerse the appliance in liquid.

- Sit the appliance on a stable, level, heat-resistant surface.
- Always turn off and unplug from the wall power outlet when not in use, before fitting or removing parts, and before cleaning the appliance.
- Do not move the product while it is in use. Always let it cool before moving, servicing, or cleaning it.
- Always clean the appliance after use.
- Don't leave the appliance unattended while plugged in.
- Don't use the appliance for any purposes other than those described in these instructions.
- Don't cover the appliance or put anything on top of it.
- Don't operate the appliance if it's damaged or malfunctions.

HOUSEHOLD USE ONLY

PARTS

- | | |
|------------------------|------------------|
| 1. Measuring spoon/cap | 3. Body |
| 2. Cover | 4. On/off switch |

BEFORE USING FOR THE FIRST TIME

- Wipe the interior and exterior surfaces with a damp cloth.

USING YOUR POPCORN MAKER

Your popcorn maker may smoke a little at first. This is normal and will soon disappear.

1. Place your popcorn maker on a flat, heat-resistant surface.
2. Set the switch to the **O** position.
3. Add popcorn kernels into the body of your popcorn maker using the measuring spoon. Don't add more than one full spoonful of kernels. Don't put anything except popcorn kernels into the body of your popcorn maker.
4. Place a bowl in front of your popcorn maker to catch the popcorn.
5. Fit the cover over the body.
6. Place the measuring spoon over the cover as shown.
7. Move the switch to the **I** position.
8. After a short time, the kernels will start popping and be collected by the bowl.

Obsah je uzamčen

Dokončete, prosím, proces objednávky.

Následně budete mít přístup k celému dokumentu.



Proč je dokument uzamčen? Nahněvat Vás rozhodně nechceme. Jsou k tomu dva hlavní důvody:

- 1) Vytvořit a udržovat obsáhlou databázi návodů stojí nejen spoustu úsilí a času, ale i finanční prostředky. Dělali byste to Vy zadarmo? Ne*. Zakoupením této služby obdržíte úplný návod a podpoříte provoz a rozvoj našich stránek. Třeba se Vám to bude ještě někdy hodit.

**) Možná zpočátku ano. Ale vězte, že dotovat to dlouhodobě nelze. A rozhodně na tom nezbohatneme.*

- 2) Pak jsou tady „roboti“, kteří se přiživují na naší práci a „vysávají“ výsledky našeho úsilí pro svůj prospěch. Tímto krokem se jim to snažíme překazit.

A pokud nemáte zájem, respektujeme to. Urgujte svého prodejce. A když neuspějete, rádi Vás uvidíme!