



Russell Hobbs



- GB
- DE
- FR
- NL
- IT
- ES
- PT
- DK
- SE
- NO
- FI
- RU
- CZ
- SK
- PL
- HR
- SI
- GR
- HU
- TR
- RO
- BG
- AE

26010-56

 www.russellhobbs.com

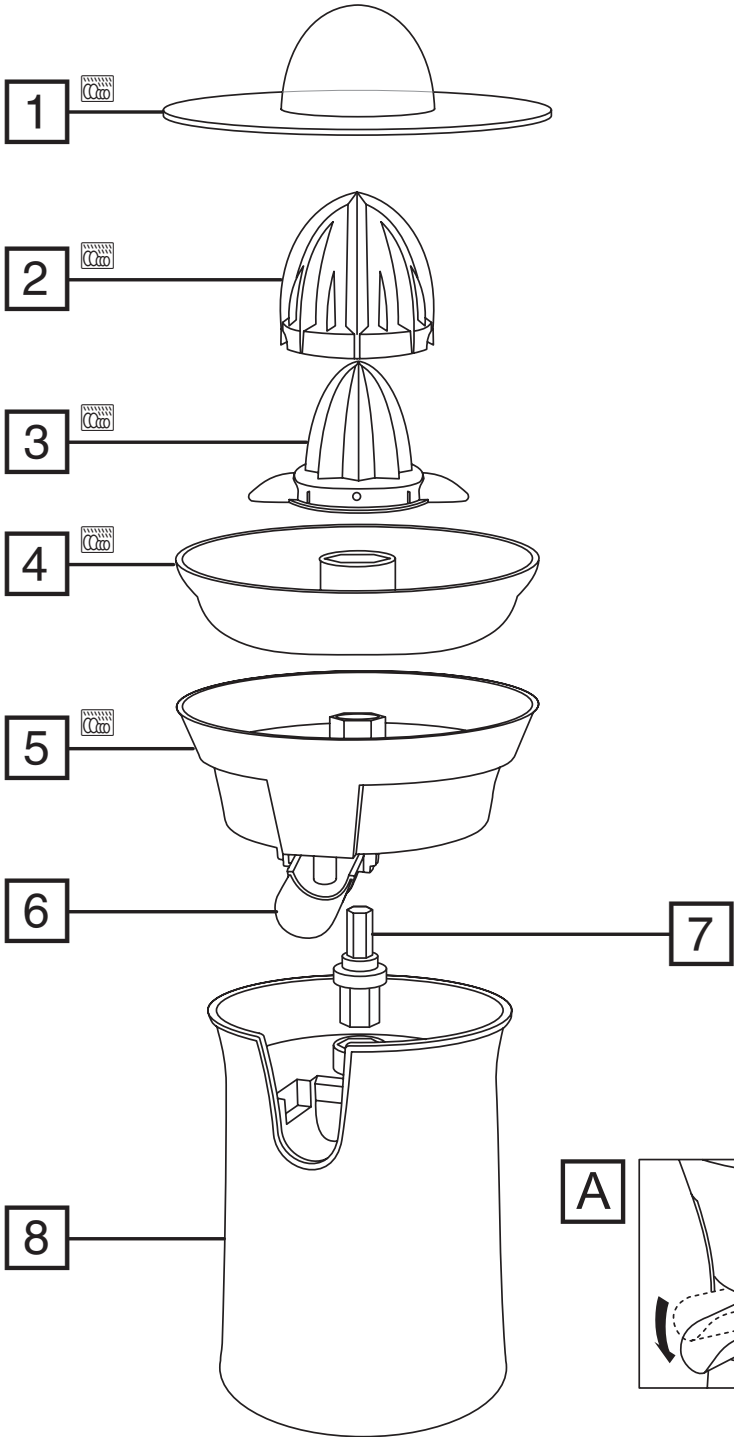

Read the instructions, keep them safe, pass them on if you pass the appliance on. Remove all packaging before use.



IMPORTANT SAFEGUARDS

Follow basic safety precautions, including:

This appliance can be used by children aged from 8 years and above and persons with reduced physical, sensory or mental capabilities or lack of experience and knowledge if they have been supervised/instructed and understand the hazards involved. Children shall not play with the appliance. Cleaning and user maintenance shall not be done by children unless they are older than 8 and supervised. Keep the appliance and cable out of reach of children under 8 years.

Misuse of the appliance may cause injury.

Unplug the appliance before assembly, disassembly, or cleaning.

Don't leave the appliance unattended while plugged in.

If the cable is damaged, it must be replaced by the manufacturer, its service agent, or someone similarly qualified, to avoid hazard.

- ⊗ Do not use this appliance near bathtubs, showers, basins or other vessels containing water.
- Sit the motor unit on a stable, level surface.
- Keep the citrus press and the cable away from hotplates, hobs or burners.
- Store the citrus press away from direct sunlight, and, if possible, from fluorescent light.
- Don't run the motor for more than 2 minutes, or it may overheat. After 2 minutes, switch off for at least 2 minutes, to let the motor cool.
- Don't use the citrus press for any purpose other than those described in these instructions.
- Don't use the citrus press if it's damaged or malfunctions.
- If the cable is damaged, return the citrus press, in order to avoid hazard.

HOUSEHOLD USE ONLY

PARTS

- | | |
|--------------------|---|
| 1. Cover | 6. Spout |
| 2. Large reamer | 7. Spindle |
| 3. Small reamer | 8. Motor unit |
| 4. Pulp collector |  Dishwasher safe |
| 5. Juice collector | |

DISMANTLING

1. Unplug the citrus press.
2. Lift the reamers off the drive shaft.
3. Grip the large reamer in one hand, and the wings of the small reamer in the other, and separate the two reamers.
4. Lift the separator off the juice collector.
5. Lift the juice collector off the motor unit.
6. Pull the drive shaft up and off the motor unit.

Obsah je uzamčen

Dokončete, prosím, proces objednávky.

Následně budete mít přístup k celému dokumentu.



Proč je dokument uzamčen? Nahněvat Vás rozhodně nechceme. Jsou k tomu dva hlavní důvody:

- 1) Vytvořit a udržovat obsáhlou databázi návodů stojí nejen spoustu úsilí a času, ale i finanční prostředky. Dělali byste to Vy zadarmo? Ne*. Zakoupením této služby obdržíte úplný návod a podpoříte provoz a rozvoj našich stránek. Třeba se Vám to bude ještě někdy hodit.

**) Možná zpočátku ano. Ale vězte, že dotovat to dlouhodobě nelze. A rozhodně na tom nezbohatneme.*

- 2) Pak jsou tady „roboti“, kteří se přiživují na naší práci a „vysávají“ výsledky našeho úsilí pro svůj prospěch. Tímto krokem se jim to snažíme překazit.

A pokud nemáte zájem, respektujeme to. Urgujte svého prodejce. A když neuspějete, rádi Vás uvidíme!