

# ROVUS®



## **2in1 MOSQUITO KILLER**

MODEL NO.: MI-H20-1002

## **USER MANUAL**

Please read this manual thoroughly before using and save it for future reference.

# ROVUS®

EN.....	3	LV.....	22
AL.....	4	MD.....	23
BG.....	6	ME.....	25
BIH.....	9	MK.....	26
CZ.....	10	PL.....	28
EE.....	11	RO.....	30
HR.....	13	RS.....	31
HU.....	15	RU.....	33
KS.....	17	SI.....	36
KZ.....	19	SK.....	38
LT.....	20	UA.....	39

(EN) PICTURES / (AL) FOTOGRAFIN / (BG) ИЛЮСТРАЦИИ / (BIH) SLIKE / (CZ) OBRÁZKY / (EE) JOONISED / (HR) SLIKE / (HU) KÉPEK / (KS) FOTOGRAFIN / (KZ) СУПЕТТЕР / (LT) PAVEIKSLIUKAI / (LV) ATTĒLI / (MD) IMAGINI / (ME) SLIKE / (MK) СЛИКИ / (PL) RYSUNKI / (RO) IMAGINI / (RS) SLIKE / (RU) RYSUNKI / (SI) SLIKE / (SK) OBRÁZKY / (UA) МАЛЮНКИ

**Picture 1**

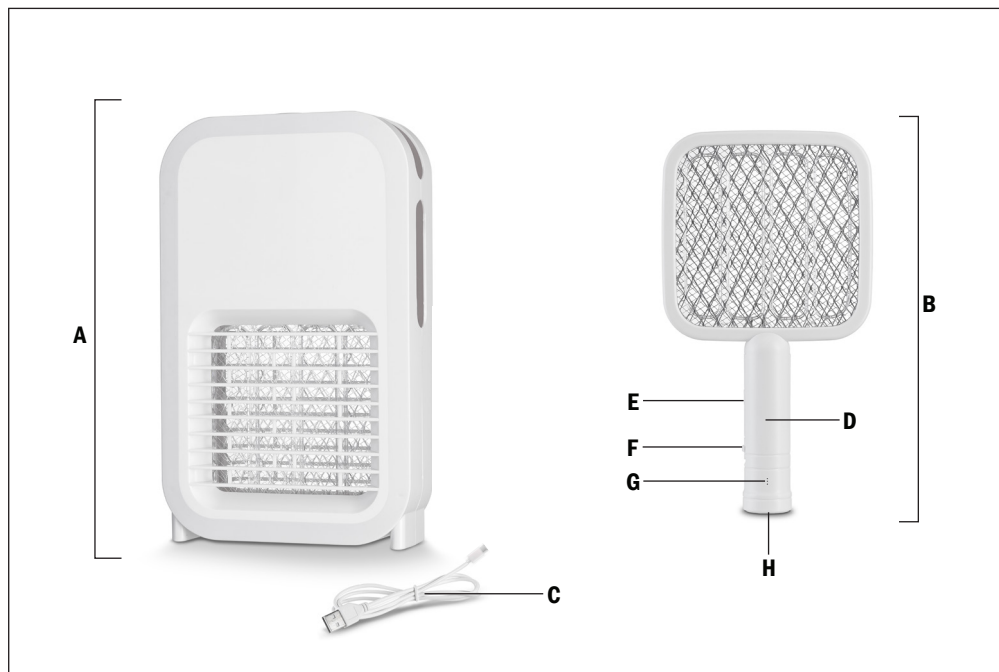

Please read this manual thoroughly before using and save it for future reference.

## WARNINGS

1. This device can be used by children aged from 8 years and above as well as by persons with reduced physical, sensory or mental capabilities or lack of experience and knowledge if they have been given supervision or instruction concerning use of the device in a safe way and understand the hazards involved. Children shall not play with the appliance. Cleaning and user maintenance should not be done by children unless they are older than 8 and supervised.
2. This device is intended for household and dry use only. It can be used on porches and gardens, but must be protected against direct sunlight, water and moisture.
3. Before use, place the product on hard, flat, stable and dry surface away from flammable or explosive sources. Do not use in barns, food drying or similar places.
4. If the device is not working as it should, has received a sharp blow, has been dropped, damaged, left outdoors or dropped in-to water, do not use it.
5. Do not attempt any modification or repair by yourself and ensure that any repair is conducted only by appropriately qualified technician.
6. If the power cable is damaged, it must be replaced immediately by authorized and qualified person only.
7. Plug in USB power supply that corresponds to the rated one on product only.
8. This device should never be switched on or stay plugged in power supply during cleaning.
9. Always turn off the device before removing it from the stand or unplugging it from power supply
10. Do not place the power cable near a heated surface.
11. This device should never be used near or in humid places (that might contain water or not) to avoid electric shock.
12. Use care when operating the device by keeping all foreign objects, fingers, body parts, hair, loose clothing and jewelry away from openings.
13. Regularly remove blockages caused by insects, dust, fluff, hair etc. because they greatly reduce device's suction power and/or general performance. Please refer to below paragraphs about details on cleaning.
14. Never touch the device when your hands are wet.
15. Although the product has been checked its usage and consequences are strictly user responsibility.
16. The appliance is to be kept out of reach of children.
17. The appliance is not to be used in locations where flammable vapour or explosive dust is likely to exist.
18. Dangerous voltage ⚡.

### 1) PARTS (see PICTURES; picture 1)

- A = stand
- B = racket
- C = power cable
- D = hand grip
- E = power button
- F = mode switch
- G = charging lights
- H = USB charging socket

### 2) BEFORE USE

- Unpack the device and place it on hard, flat, stable and dry surface away from any water or humidity.
- Charge the device (for at least 8 hours before first use) by plugging one end of the power cable into USB charging socket and the other in power supply (USB charger, power bank, computer etc.).

# Obsah je uzamčen

**Dokončete, prosím, proces objednávky.**

**Následně budete mít přístup k celému dokumentu.**



**Proč je dokument uzamčen? Nahněvat Vás rozhodně nechceme. Jsou k tomu dva hlavní důvody:**

- 1) Vytvořit a udržovat obsáhlou databázi návodů stojí nejen spoustu úsilí a času, ale i finanční prostředky. Dělali byste to Vy zadarmo? Ne\*. Zakoupením této služby obdržíte úplný návod a podpoříte provoz a rozvoj našich stránek. Třeba se Vám to bude ještě někdy hodit.

*\*) Možná zpočátku ano. Ale vězte, že dotovat to dlouhodobě nelze. A rozhodně na tom nezbohatneme.*

- 2) Pak jsou tady „roboti“, kteří se přiživují na naší práci a „vysávají“ výsledky našeho úsilí pro svůj prospěch. Tímto krokem se jim to snažíme překazit.

A pokud nemáte zájem, respektujeme to. Urgujte svého prodejce. A když neuspějete, rádi Vás uvidíme!