

# Quick Start Guide

RP-AC51  
Wi-Fi AC Repeater

E12398 / First Edition / March 2017

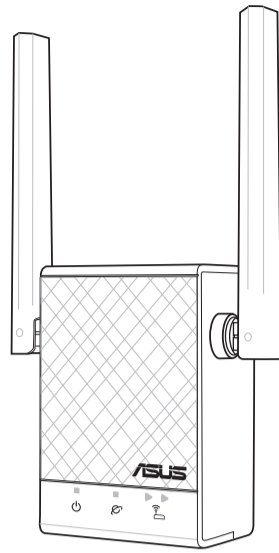

## LED explanations

- POWER**  
On: RP-AC51 is power on.  
Off: RP-AC51 is power off.
- EXISTING NETWORK**  
On: Connected to the router/AP.  
Off: Not connected to the router/AP.
- MOVE CLOSER**  
Need to move RP-AC51 closer to the router/AP.
- MOVE AWAY SLIGHTLY**  
Need to move RP-AC51 slightly away from the router/AP.

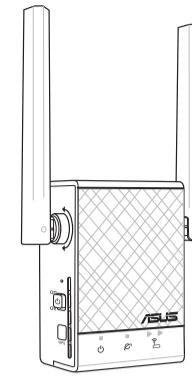

## Button explanations

- POWER SWITCH**  
Switch this button on/off to turn RP-AC51 on/off.
- WPS BUTTON**  
Press this button to quickly connect to the router/AP via the WPS method.

## RESET BUTTON

Use a pin to push this button to reset RP-AC51 to its factory default settings.

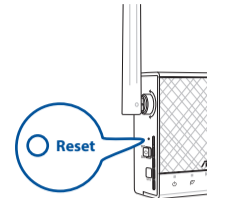

## BEFORE SETUP WE SUGGEST...

### 01 Placing your RP-AC51

- 1 Place your RP-AC51 near your router/AP.
- 2 Check the LEDs and see the LED explanations.

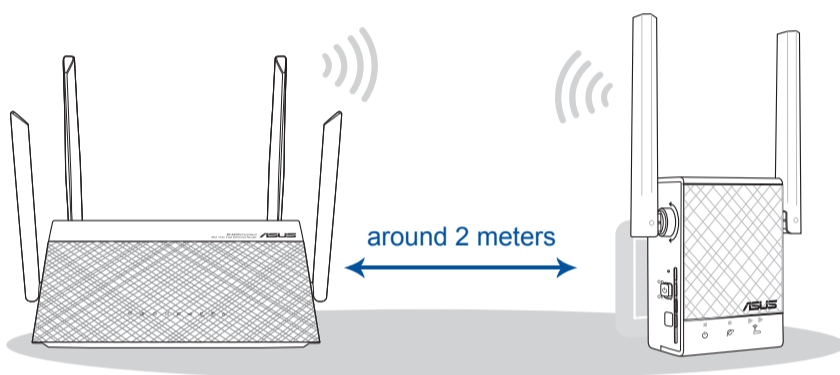

### 02 Power On

- 1 Plug your RP-AC51 to a power outlet.
- 2 Turn on the power switch.

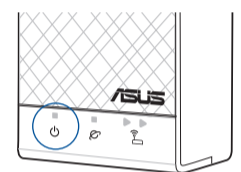
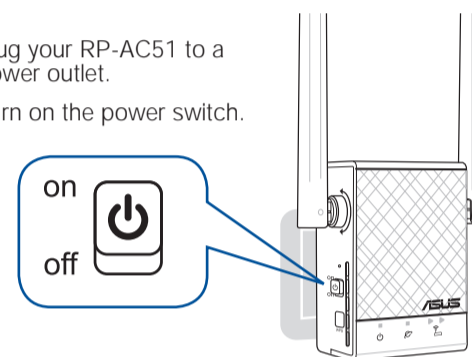

Wait until the power LED turns blue, indicating that your RP-AC51 is ready to connect to your existing router/AP.

## SETUP METHODS

### METHOD 1 APP SUPPORT

#### 01 Download the app



#### 02 Use the app

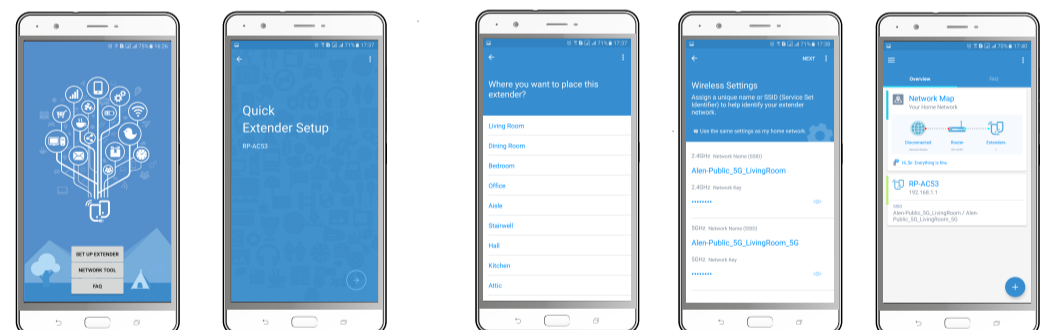

- 1 Tap **SET UP EXTENDER**.
- 2 Open your phone Wi-Fi, and connect to your RP-AC51's SSID.
- 3 Follow the Quick Extender Setup instructions.
- 4 Assign a unique network name (SSID) for your extended network.
- 5 Wait until the setup is completed.

### METHOD 2 WPS SUPPORT

#### 01 Connect via WPS

- 1 Press the WPS button on your router/AP.

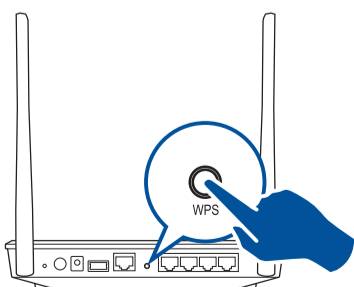

- 2 Press the WPS button on your RP-AC51 for more than two (2) seconds until the power LED starts to blink.

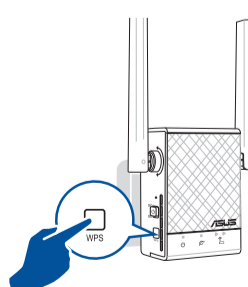

**NOTE:** Wait until the existing network LED blinks for about two (2) minutes, then turns solid blue, indicating the WPS process is completed.

#### 02 Enjoy Wi-Fi

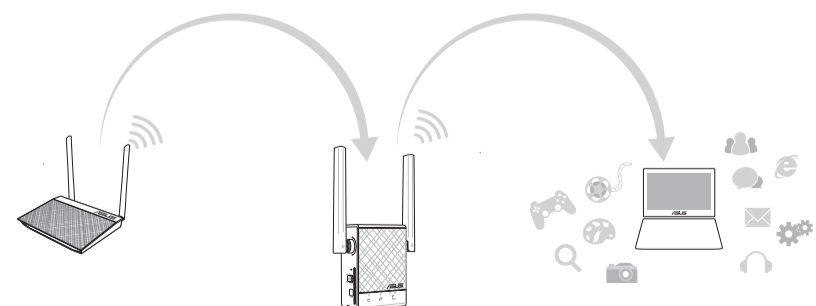

Your RP-AC51's wireless network name (SSID) changes to your existing Wi-Fi network name, ending with **\_RPT** or **\_RPT5G** and shares your router/AP's Wireless Password.

# Obsah je uzamčen

**Dokončete, prosím, proces objednávky.**

**Následně budete mít přístup k celému dokumentu.**



**Proč je dokument uzamčen? Nahněvat Vás rozhodně nechceme. Jsou k tomu dva hlavní důvody:**

- 1) Vytvořit a udržovat obsáhlou databázi návodů stojí nejen spoustu úsilí a času, ale i finanční prostředky. Dělali byste to Vy zadarmo? Ne\*. Zakoupením této služby obdržíte úplný návod a podpoříte provoz a rozvoj našich stránek. Třeba se Vám to bude ještě někdy hodit.

*\*) Možná zpočátku ano. Ale vězte, že dotovat to dlouhodobě nelze. A rozhodně na tom nezbohatneme.*

- 2) Pak jsou tady „roboti“, kteří se přiživují na naší práci a „vysávají“ výsledky našeho úsilí pro svůj prospěch. Tímto krokem se jim to snažíme překazit.

A pokud nemáte zájem, respektujeme to. Urgujte svého prodejce. A když neuspějete, rádi Vás uvidíme!