



netis Wireless Dual Band Router  
**Quick Installation Guide**





# 1.Package Contents

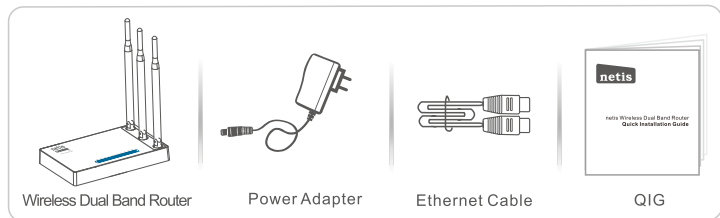

\*This QIG is for all netis wireless dual band routers, including models- WF2471, WF2471D, WF2710, WF2710D, WF2722, WF2722D, WF2780, WF2780D, WF2891, WF2891D, etc.

\* The product model shown in this QIG is WF2710, as an example.

# 2.Hardware Connection

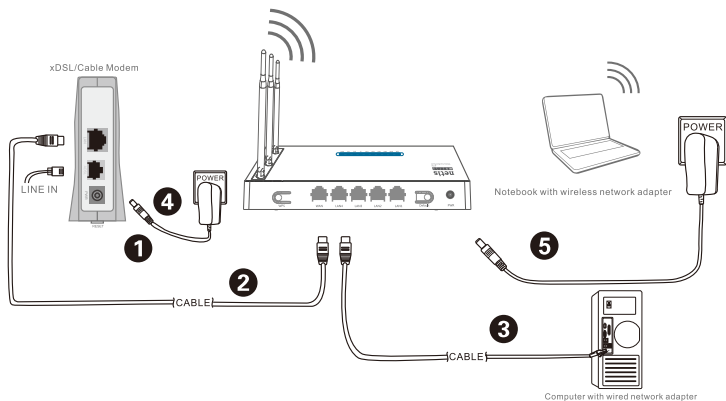

2.1. Power off your Modem.

2.2. Connect the **WAN** port on netis Router to the Modem's **LAN** port with an Ethernet cable.

2.3. Connect your computer to one of the **LAN** ports on netis Router with an Ethernet cable.

2.4. Power on your Modem.

2.5. Plug the provided Power Adapter into the **PWR** jack of netis Router and the other end to a standard electrical socket. Then wait for one minute.

## 3. Configure the Router via Web Management Page

3.1. Set the IP address of the wired network adapter on your computer as **“Automatic”** or **“DHCP”**.

### For Windows 8/ 7/Vista

- 1) Go to **“Settings”** (Win 8)/ **“Start”** (Win 7/Vista) > **“Control Panel”**.
- 2) Left-click on **“Network and Internet”** > **“Network and Sharing Center”** > **“Change adapter settings”** (Win 8/7)/ **“Manage network connections”** (Win Vista).
- 3) Right-click on **“Local Area Connection”** and left-click on **“Properties”**.
- 4) Double-click on **“Internet Protocol Version 4 (TCP/IPv4)”**.
- 5) Select **“Obtain an IP address automatically”** and **“Obtain DNS server address automatically”** then left-click on **“OK”**.

### For Windows XP/2000

- 1) Go to **“Start”** > **“Control Panel”**.
- 2) Left-click on **“Network and Internet Connections”** > **“Network Connections”**.
- 3) Right-click on **“Local Area Connection”** and left-click on **“Properties”**.
- 4) Double-click on **“Internet Protocol (TCP/IP)”**.
- 5) Select **“Obtain an IP address automatically”** and **“Obtain DNS server address automatically”** then left-click on **“OK”**.

### For MAC OS

- 1) Click on the **“Apple”** menu > **“System Preferences”**.
- 2) Click on the **“Network”** icon.
- 3) Click on **“Ethernet”** in the left side box and click on **“Advanced”** in the lower right corner.
- 4) In the top options, select **“TCP/IP”**.
- 5) In the pull-down menu next to **“Configure Ipv4”**, select **“Using DHCP”**.
- 6) Click **“OK”** then **“Apply”**.

3.2. Open your browser and type **http://netis.cc** in the address field to visit router's web management page.



3. 3. Select the language as you need on the top box, default is in English.

1) In “**Quick Setup**” page, select your **Internet Connection Type**.

If “**DHCP (Cable Modem)**” is selected, the router will automatically receive the IP parameters from your ISP (Internet Service Provider).

If “**Static IP**” is selected, please enter the **IP Address/Subnet Mask/Default Gateway/DNS Servers** given by your ISP.

If “**PPPoE**” is selected, please enter the **Username** and **Password** given by your ISP.

2) Under **Wireless Setup**, configure your wireless network name (SSID) and password.

3) Left-click on “**Save**” to make your settings take effect.

The screenshot shows the netis router's configuration interface. At the top, there is a language dropdown menu set to 'English' and an 'Advanced' button with a gear icon. The main heading is 'Quick Setup'. Below this, there are two main sections: 'Internet Connection Type' and 'Wireless Setup'. In the 'Internet Connection Type' section, there is a blue cloud icon labeled 'internet' and four radio button options: 'DHCP' (selected), 'Static IP', 'PPPoE', and 'Other'. The 'Wireless Setup' section features a green wireless signal icon labeled 'Wireless' and a table of settings for two bands: 2.4G and 5G. For each band, there are fields for SSID (both set to 'netis\_2.4G\_30E6CE' and 'netis\_5G\_30E6CE'), Security (both set to 'Enable'), and Password (both set to 'password'). A 'Save' button is located at the bottom center of the page.

#### Tip 1:

Access address: <http://netis.cc>

2.4G default SSID: netis\_2.4G\_XXXXXX 5G default SSID: netis\_5G\_XXXXXX

Default wireless password: password

(XXXXXX: Last 6 digits of LAN MAC Address)

#### Tip 2:

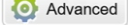
You can click on  button on the top for other Internet connection types and further settings.

## 4. Troubleshooting

**Q** How do I restore my netis Router's configuration to its default settings?

**A** With the router powered on, use a pin to press and hold the **Default** button on the rear panel for 8 to 10 seconds before releasing it. The router will reboot and all configurations are back to factory default.

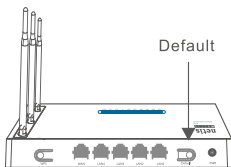

**Q** What can I do if my Internet cannot be accessed?

**A** 1) Check to verify the hardware connections are correct. Please refer to the **“Hardware Connection”** step.  
 2) Login to netis Router's web management page and ensure that you set the correct Internet Connection Type. For cable modem users, please configure **“MAC Clone”** additionally.

On the left-side menu, left-click on  **Advanced** > **“Network”** > **“WAN”**. And in the middle page, left-click on **“Advanced”** > **“MAC Clone”** and then **“Save”** it.

MAC Address : 08:10:76:3a:70:fb

MAC Clone

Default MAC

- 3) Reboot the modem first and then netis Router. Wait for one minute before you check the Internet again.
- 4) If Internet access is not available, please connect your computer directly to your modem and try the Internet again. If the Internet is still not working, please contact your ISP for further help.

### Technical Support:

#### USA/ Canada:

Toll Free: +1 866 71 network (+1 866 716 3896)

E-mail: [usa\\_support@netis-systems.com](mailto:usa_support@netis-systems.com)

#### Other Regions:

E-mail: [support@netis-systems.com](mailto:support@netis-systems.com)

NETIS SYSTEMS CO., LTD.

[www.netis-systems.com](http://www.netis-systems.com)

MADE IN CHINA



Router Inalámbrico de Doble Banda netis  
**Guía de Instalación Rápida**



# 1. Contenido del Empaque

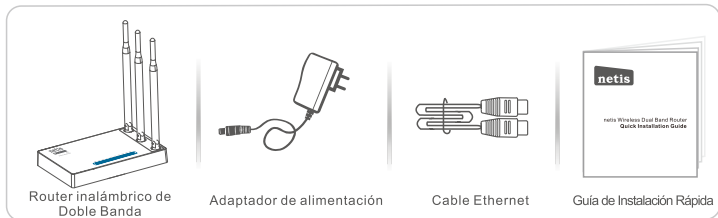

\*Esta guía de instalación rápida es para todos los router inalámbricos netis de doble banda, incluidos los modelos- WF2471, WF2471D, WF2710, WF2710D, WF2722, WF2722D, WF2780, WF2780D, WF2891, WF2891D, etc.

\*El ejemplo del modelo del producto que se muestra en esta Guía de Instalación Rápida es WF2710.

# 2. Conexión del Hardware

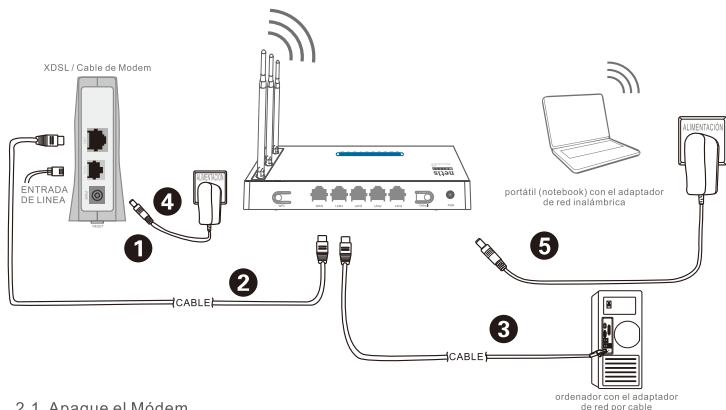

2.1. Apague el Módem.

2.2. Conecte el puerto de **red de área amplia (WAN)** del Router netis al puerto de **red de área local (LAN)** del módem con un cable Ethernet.

2.3. Conecte su ordenador a uno de los puertos de **red de área local (LAN)** del router netis con un cable Ethernet.

2.4. Encienda el Módem.

2.5. Conecte el adaptador de alimentación suministrado en el conector de **alimentación (PWR)** del router netis y el otro extremo a una toma de corriente estándar. Luego, espere durante un minuto.